

# ILLUSTRATED PARTS LIST

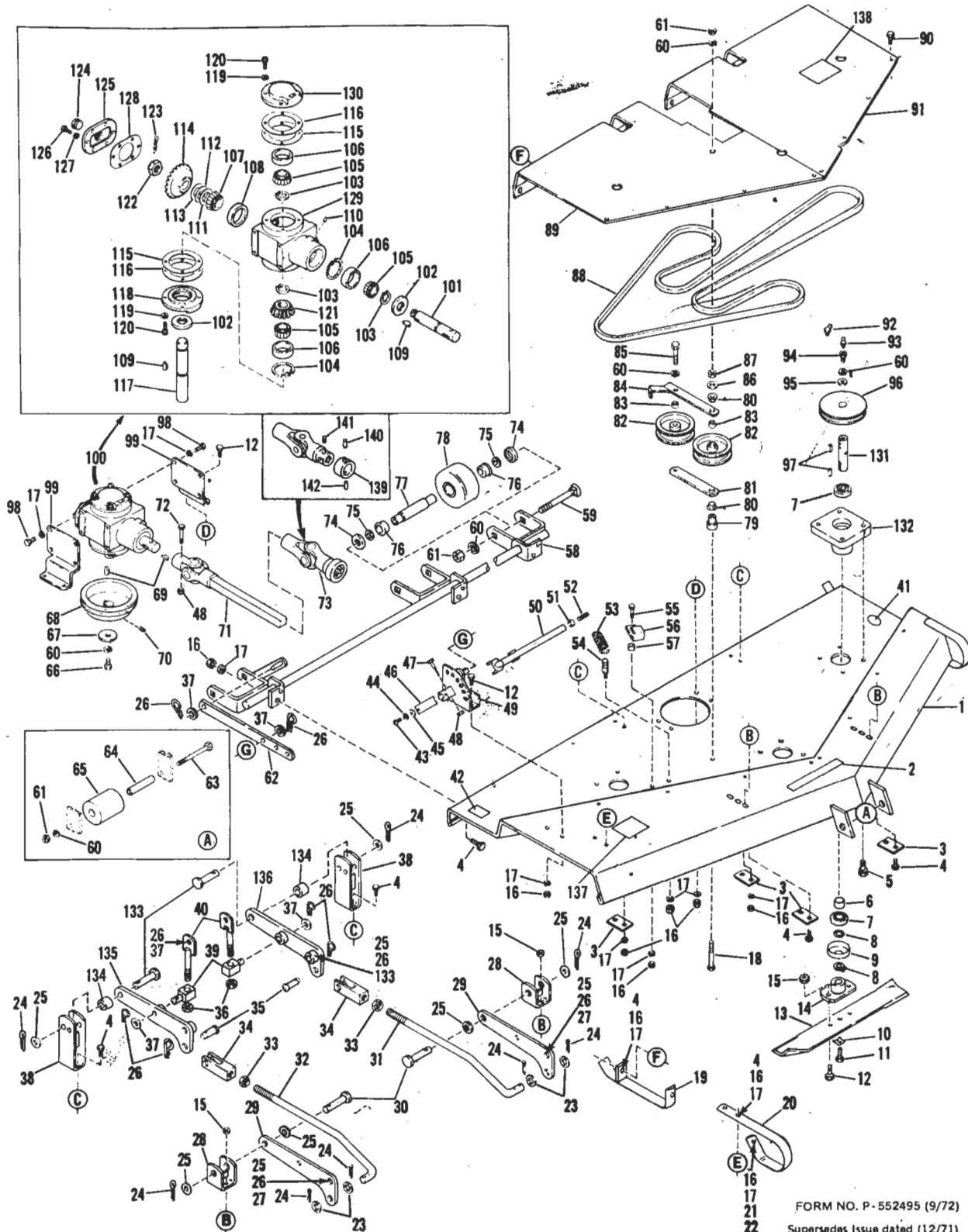

FMC CORPORATION.  
54 INCH CENTER MOUNTED  
ROTARY MOWER ATTACHMENT  
MODEL 18070-02



**ROTARY MOWER MODEL 18070-02**

| Ref. No. | Part No. | Description                                | No. Req'd. |
|----------|----------|--|------------|
| 1        | 1722 912 | Base Assembly                              | 1          |
| 2        | 1715 633 | Decal (Bolens)                             | 1          |
| 3        | 1720 372 | Support Plate                              | 4          |
| 4        | 1100 078 | Capscrew, 5/16-18 x 7/8                    | 18         |
| 5        | 1185 670 | Capscrew, 5/16-18 x 7/8<br>with Lockwasher | 12         |
| 6        | 1720 999 | Spacer                                     | 3          |
| 7        | 1185 828 | Ball Bearing                               | 6          |
| 8        | 1185 708 | Retaining Ring                             | 6          |
| 9        | 1716 744 | Cap  | 3          |
| 10       | 1185 715 | Lockwasher, 3/8<br>(Pyramidal Type)        | 3          |
| 11       | 1100 009 | Capscrew, 3/8-24 x 1                       | 3          |
| 12       | 1100 044 | Capscrew, 5/16-18 x 3/4                    | 12         |
| 13       | 1722 883 | Cutter Blade                               | 3          |
| 14       | 1722.882 | Hub Assembly                               | 3          |
| 15       | 1110 107 | Lock Nut, 5/16-18                          | 10         |
| 16       | 1186 230 | Hex Nut, 5/16-18                           | 23         |
| 17       | 1100 242 | Lockwasher, 5/16                           | 31         |
| 18       | 1111 614 | Capscrew, 3/8-16 x 3                       | 1          |
| 19       | 1722 899 | Rear Runner Assembly                       | 1          |
| 20       | 1722 896 | Right Hand Runner                          | 1          |
| 21       | 1100 043 | Capscrew, 5/16-18 x 1                      | 1          |
| 22       | 1803 327 | Flat Washer, 5/16                          | 1          |
| 23       | 1107 387 | Flat Washer, 3/8                           | 4          |
| 24       | 1100 351 | Cotter Pin, 1/8 x 1-1/4                    | 8          |
| 25       | 1107 386 | Flat Washer, 5/8                           | 12         |
| 26       | 1723 478 | Spring Cotter                              | 12         |
| 27       | 1713 501 | Clevis Pin                                 | 2          |
| 28       | 1722 947 | Lift Bracket Assy., Front                  | 2          |
| 29       | 1722 726 | Right Hand Link                            | 2          |
| 30       | 1708 040 | Clevis Pin                                 | 2          |
| 31       | 1722 805 | Left Hand Rod                              | 1          |
| 32       | 1722 806 | Right Hand Rod                             | 1          |
| 33       | 1186 235 | Hex Nut, 5/8-11                            | 2          |
| 34       | 1714 573 | Rod End                                    | 2          |
| 35       | 1719 324 | Clevis Pin                                 | 2          |
| 36       | 1110 110 | Lock Nut, 1/2-13                           | 2          |
| 37       | 1107 385 | Flat Washer, 1/2                           | 6          |
| 38       | 1722 720 | Rear Lift Bracket Assy.                    | 2          |
| 39       | 1724 316 | Stud                                       | 2          |
| 40       | 1715 404 | Link Assembly                              | 2          |
| 41       | 1722 725 | Decal (Caution)                            | 1          |
| 42       | 1715 670 | Decal (Caution)                            | 1          |
| 43       | 1114 748 | Machine Screw, #10-32 x 1/2                | 1          |
| 44       | 1100 240 | Lockwasher, #10                            | 1          |
| 45       | 1103 959 | Flat Washer, #10                           | 1          |
| 46       | 1718 655 | Spring                                     | 1          |
| 47       | 1100 811 | Capscrew, 1/4-20 x 1-1/2                   | 1          |
| 48       | 1110 106 | Lock Nut, 1/4-20                           | 2          |
| 49       | 1718 667 | Quadrant Assembly                          | 1          |
| 50       | 1718 664 | Handle Assembly                            | 1          |
| 51       | 1719 328 | Spacer                                     | 1          |
| 52       | 1185 400 | Roll Pin, 5/16 x 1-1/4                     | 1          |
| 53       | 1706 822 | Extension Spring                           | 1          |
| 54       | 1715 210 | Spring Anchor Bolt                         | 1          |
| 55       | 1100 799 | Capscrew, 5/16-18 x 1-1/2                  | 1          |
| 56       | 1719 338 | Belt Guide                                 | 1          |
| 57       | 1722 948 | Spacer                                     | 1          |
| 58       | 1722 894 | Wheel Yoke Assembly                        | 1          |
| 59       | 1186 143 | Carr. Bolt, 3/8-16 x 4-1/2                 | 3          |
| 60       | 1100 243 | Lockwasher, 3/8                            | 10         |
| 61       | 1186 231 | Hex Nut, 3/8-16                            | 5          |
| 62       | 1722 888 | Lift Link                                  | 1          |
| 63       | 1103 230 | Capscrew, 3/8-16 x 6                       | 1          |
| 64       | 1720 578 | Spacer                                     | 1          |
| 65       | 1720 577 | Roller                                     | 1          |
| 66       | 1111 708 | Capscrew, 3/8-24 x 5/8                     | 1          |
| 67       | 1703 052 | Flat Washer                                | 1          |
| 68       | 1718 659 | Sheave                                     | 1          |
| 69       | 1100 276 | Woodruff Key, 1/4 x 7/8                    | 2          |
| 70       | 1103 466 | Set Screw, 5/16-18 x 3/8                   | 2          |
| *71      | 1722 632 | Drive Assembly                             | 1          |
| 72       | 1111 601 | Capscrew, 1/4-20 x 1-3/4                   | 1          |

| Ref. No. | Part No. | Description   | No. Req'd. |
|----------|----------|---|------------|
| *73      | 1722 918 | Universal Joint Assy. (Incl.<br>Ref. Nos. 139 thru 142)       | 1          |
| 74       | 1894 386 | Cupped Washer   | 6          |
| 75       | 1705 108 | Flat Washer   | 6          |
| 76       | 1185 695 | Ball Bearing  | 6          |
| 77       | 1717 737 | Bearing Axle  | 3          |
| 78       | 1717 649 | Roller  | 3          |
| 79       | 1722 884 | Idler Spacer  | 1          |
| 80       | 1714 299 | Nylon Bushing   | 2          |
| 81       | 1718 649 | Idler Arm   | 1          |
| 82       | 1724 488 | Idler Pulley  | 2          |
| 83       | 1718 651 | Spacer  | 2          |
| 84       | 1718 642 | Idler Arm Assembly  | 1          |
| 85       | 1100 012 | Capscrew, 3/8-24 x 1-3/4                                      | 1          |
| 86       | 1100 265 | Flat Washer   | 1          |
| 87       | 1186 259 | Jam Nut, 3/8-16   | 1          |
| 88       | 1718 653 | V-Belt  | 1          |
| 89       | 1722 903 | Right Hand Belt Cover   | 1          |
| 90       | 1185 712 | Self Thread Screw,<br>#10-20 x 1/2                            | 17         |
| 91       | 1722 902 | Left Hand Belt Cover  | 1          |
| 92       | 1110 086 | Grease Fitting, 45°   | 1          |
| 93       | 1104 954 | Grease Fitting  | 1          |
| 94       | 1719 331 | Bolt  | 3          |
| 95       | 1701 055 | Flat Washer   | 3          |
| 96       | 1722 886 | Pulley  | 3          |
| 97       | 1108 852 | Square Key, 3/16 x 3/4  | 6          |
| 98       | 1103 195 | Capscrew, 5/16-18 x 5/8                                       | 8          |
| 99       | 1722 901 | Support Bracket   | 2          |
| 100      | 1718 650 | Gear Box Assembly   | 1          |
| 101      | 1718 622 | Input Shaft   | 1          |
| 102      | 1185 687 | Oil Seal  | 2          |
| 103      | 1185 689 | Retaining Ring  | 3          |
| 104      | 1118 735 | Retaining Ring  | 2          |
| 105      | 1185 661 | Bearing Cone  | 3          |
| 106      | 1185 660 | Bearing Cup   | 3          |
| 107      | 1185 688 | Bearing Cone  | 1          |
| 108      | 1185 118 | Bearing Cup   | 1          |
| 109      | 1709 611 | Woodruff Key, 1/4 x 7/8                                       | 2          |
| 110      | 182 682  | Breather  | 1          |
| 111      | 1800 750 | Shim, 1-1/2 x .003  | 1          |
| 112      | 1800 751 | Shim, 1-1/2 x .005  | 1          |
| 113      | 1800 338 | Shim, .015  | 1          |
| 114      | 1717 459 | Gear, 29 T  | 1          |
| 115      | 1717 456 | Gasket  | 10         |
| 116      | 1719 501 | Gasket  | 2          |
| 117      | 1718 621 | Shaft, Output   | 1          |
| 118      | 1717 454 | Bearing Retainer  | 1          |
| 119      | 1100 242 | Lockwasher, 5/16  | 8          |
| 120      | 1185 686 | Capscrew, 5/16-18 x 3/4                                       | 8          |
| 121      | 1717 457 | Bevel Pinion, 18 T  | 1          |
| 122      | 1185 662 | Slotted Nut, 7/8-14 UNF                                       | 1          |
| 123      | 1100 352 | Cotter Pin, 1/8 x 1-1/2                                       | 1          |
| 124      | 1185 685 | Plug, 3/4-14 NPT  | 1          |
| 125      | 1717 448 | Cover   | 1          |
| 126      | 1185 684 | Capscrew, 1/4-20 x 5/8  | 6          |
| 127      | 1100 241 | Lockwasher, 1/4   | 6          |
| 128      | 1717 449 | Gasket Cover  | 1          |
| 129      | 1719 710 | Gear Case (Incl. Ref. Nos.<br>107, 108, 111, 112,<br>and 113) | 1          |
| 130      | 1718 620 | Bearing Retainer  | 1          |
| 131      | 1722 887 | Drive Shaft   | 3          |
| 132      | 1722 865 | Bearing Housing   | 3          |
| 133      | 1718 772 | Clevis Pin  | 4          |
| 134      | 1718 555 | Tubular Spacer  | 2          |
| 135      | 1724 317 | Right Hand Link   | 1          |
| 136      | 1724 318 | Left Hand Link  | 1          |
| 137      | 1723 109 | Decal (Cutting Hgt. Adj.)                                     | 1          |
| 138      | 1724 540 | Decal (Belt Drive)  | 1          |
| 139      | 1722 914 | Lock Collar   | 1          |
| 140      | 1185 917 | Drive Pin, 7/32 x 1/2   | 1          |
| 141      | 1722 916 | Spring  | 1          |
| 142      | 1185 916 | Groove Pin, 3/16 x 3/8  | 1          |

\*1714 207 Repair Kit for Joint Marked 6N

\*1714 208 Repair Kit for Joint Marked NEAPCO



PORT WASHINGTON, WISCONSIN, U.S.A.

FORM NO. P-552495 (9/72)

Supersedes Issue dated (12/71)