



BOLENS DIVISION

PORT WASHINGTON, WISCONSIN
America's Finest Outdoor Power Equipment

SERVICE BULLETIN

#193

October 21, 1971

TO: ALL BOLENS DISTRIBUTORS & DEALERS

SUBJECT: FIELD KIT #172-4344 FOR BOLENS MODEL
18070-01 54" MOWER

The above subject 18070-01 54" mower has now been superceded by a -02 mower. To update the -01 to the latest specifications, Kit #172-4344 consisting of the following parts is now available through your normal parts upplier.

- 2 - #172-4316 Swivel Stud
- 1 - #172-4317 Right Hand Link Assembly
- 1 - #172-4318 Left Hand Link Assembly
- 4 - #171-8772 Clevis Pin
- 2 - #171-8555 Tubular Spacer

Installation instructions are as follows:

- A. Install Right #172-4317 and Left Link #172-4318 Assemblies between uprights of rear lift brackets, see "A" figure 1.
- B. Place tubular spacer between NEW link assembly and outside upright of rear lift bracket, see "B" figure 1.
- C. Secure with clevis pin #171-8772 through the rear hole of rear lift brackets, see "C" figure 1.
- D. Attach clevis of leveler rods to the front lower hole of that NEW lift assemblies. See "F" figure 1.
- E. Attach NEW swivel studs #172-4316 to NEW rear lift link assemblies, see "D" figure 1.
- F. Remove the lift links from original rear lift swivel studs and assemble into NEW swivel studs, see "E" figure 1.

IMPORTANT: Install upper end of lift link so the FLUSH SIDE of link is now facing toward inside of tractor.

Sincerely,

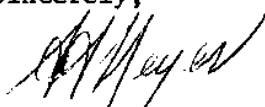

Arnold A. Meyer
Service Manager

AAM:rmh

(SEE FIGURE 1 ON REVERSE SIDE)

FIGURE 1

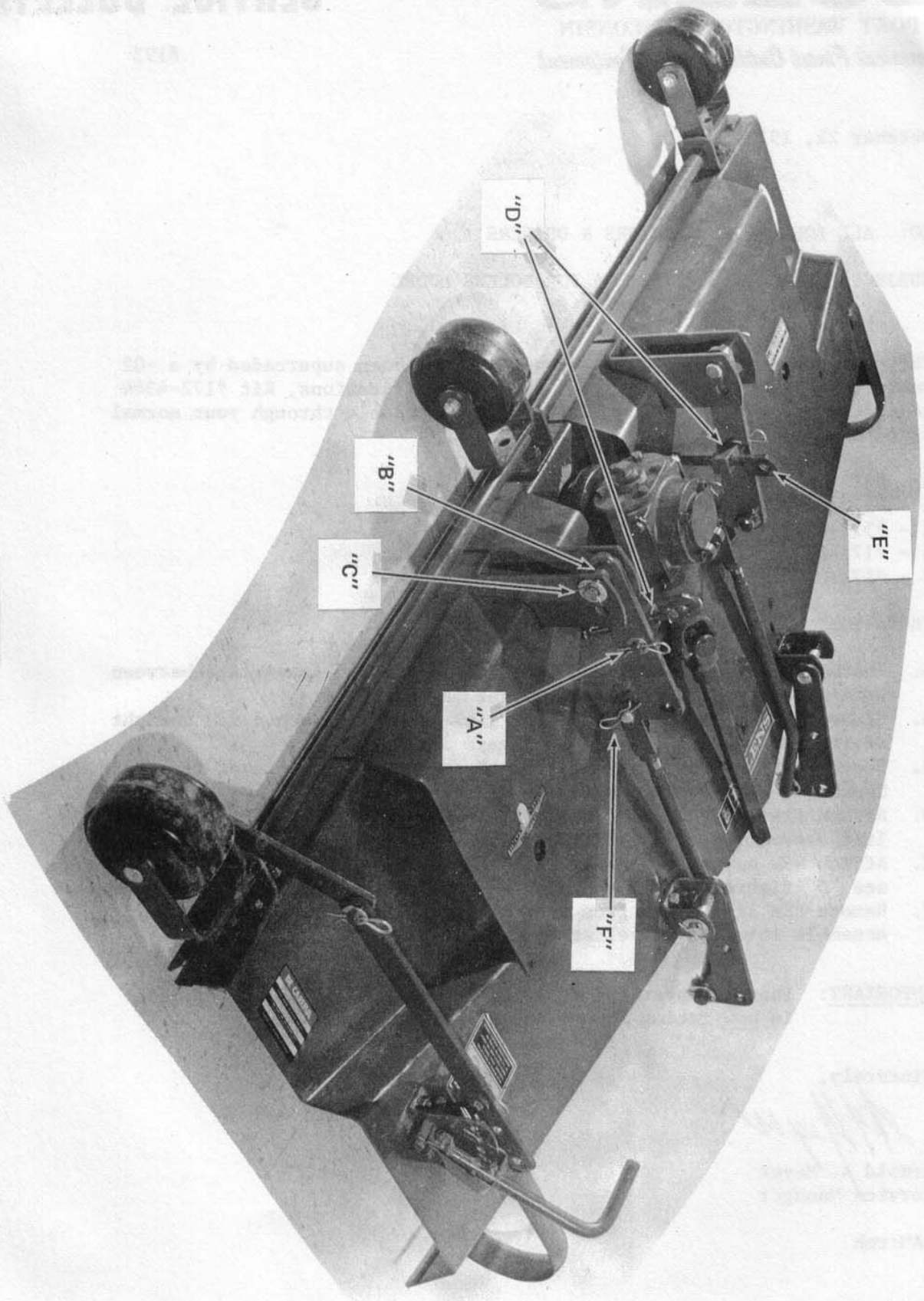

BOLENS

**ROTARY MOWER
ATTACHMENT 54 INCH
MODEL 18070-01**

**OWNER OPERATION AND
MAINTENANCE MANUAL**

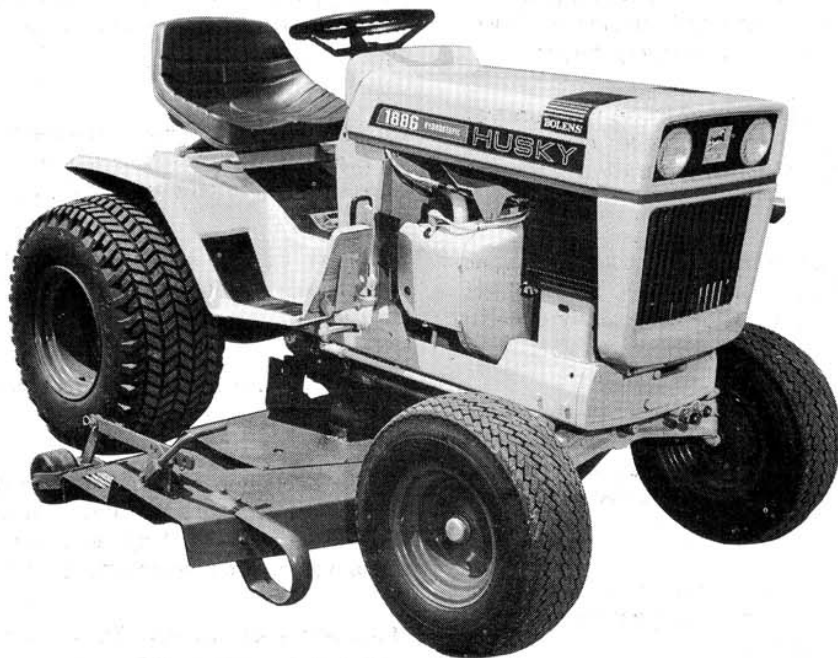

TO THE OWNER

This is an operational and general maintenance manual only and does not cover major repair. All major repair work must be performed by an authorized BOLENS DEALER, or the factory warranty is void. Bolens equipment is carefully engineered to give good performance if properly operated and maintained. Keep your equipment clean and lubricate it as prescribed in this manual. Periodically inspect your unit and perform any upkeep maintenance necessary.

Your dealer is obligated by the factory to completely assemble and service new equipment prior to first delivery, and thoroughly explain and demonstrate its operation. He will repair or replace any parts which fail due to defective material and/or workmanship during the warranty period, and also provide future repair service and supply genuine factory repair parts.

IN EVENT OF ANY PROBLEM OR PARTS REQUIRED ALWAYS CONTACT YOUR DEALER. DO NOT RETURN PARTS TO THE FACTORY. WE REQUIRE PRIOR FACTORY APPROVAL ON RETURNS, AND APPROVALS ARE ISSUED ONLY TO BOLENS DEALERS OR DISTRIBUTORS.

GENERAL SAFETY PRECAUTIONS

Preventing accidents is the responsibility of every equipment operator. The following general safety precautions *must* be fully understood and followed by every operator of this equipment. Review them frequently and NEVER TAKE CHANCES. BE CAREFUL BEFORE, DURING AND RIGHT AFTER USE OF ANY POWERED EQUIPMENT. ACCIDENTS CAN BE PREVENTED.

1. Regard your mower as a piece of power equipment. Teach this to all who operate the equipment. Power equipment not properly operated can be very dangerous.

2. Children shall not be allowed to operate unit at any time. The average child is not capable of coping with the intricacies of operating a power tool.

3. Be sure you know how to stop the mower and engine quickly, in case a child, or another person, pet or object suddenly appears in the path of or dangerously close to unit.

4. Before using mower, clear the entire lawn area of all debris that could be thrown by the blade. Debris can be ejected at high velocity out of the discharge chute, causing injury to persons or pets and damage to objects the debris would strike.

5. When you mow on rough terrain, in high grass, the mower should be set at the highest cutting level to minimize possible ejection of debris.

6. Mow only during daylight hours. If you mowed after sundown you may not be able to see any object accidentally left on the lawn. Artificial lighting may not be enough to illuminate the area to be mowed.

7. Be alert at all times. Give complete and undivided attention to the job you are doing. This should minimize the possibility of getting into dangerous situations.

8. No persons should be allowed in or near working area when mower is being used, particularly small children. This will minimize the possibility of any persons being injured by the mower or debris ejected by the mower.

9. Disengage mower and stop the engine whenever you leave the tractor. This will help prevent runaways and/or injury to children or another person.

10. When operating over uneven terrain and slopes use extreme care and make sure of solid firm footing at all times. This will help prevent both the operator from being thrown from unit or the unit being upset accidentally.

11. Use special care when mowing near objects to prevent the blades from striking them, as severe damage could result.

12. Stop the tractor and disengage mower when any other person approaches. Do not pass or stand on the grass discharge side of the mower or allow anyone else to do so with the engine running. Objects such as wire, sticks, stones, small toys and etc. can be ejected at high velocity out of the discharge chute.

13. Do not carry passengers. The passengers could fall off unit, receiving injuries.

14. Engine must be stopped and spark plug wire disconnected before adjusting mower, or changing attachments. A gasoline engine can be started if the blade or P.T.O. shaft is turned in the course of making adjustments or repairs and injury could result.

15. Efficient mowing results and maximum safety can only be expected if the mower is maintained and operated correctly. Keep mower free of excess grease and oil.

16. Never wear loose clothing when operating unit. It could become entangled in moving parts, causing injury to the wearer.

17. Always wear shoes when operating unit to give your feet as much protection as possible.

18. Do not allow adults to operate unit without proper instructions, including all safety instructions. In doing so, you will be sure they know how to operate unit properly and also are aware of all the safety precautions.

19. Study your manual. Know your equipment before operating it. Take time to operate the unit in the safest manner.

20. Always follow manufacturer's operational suggestions for most efficient and safest operation of unit.

21. Always make certain no one is in the way before using reverse. This will avoid the possibility of running over any bystanders or pets who might be in the area in back of the unit.

22. After striking a foreign object the mower should be stopped and the engine shut off and the unit inspected for any damage. If any damage has occurred the damage should be repaired before restarting and operating the unit. This is necessary to avoid further damage to the unit, uneven cuts etc., and/or possible injury to the operator or bystanders.

MODEL NUMBER

To ensure prompt service when repairs or adjustments are required, your Bolens Dealer must have the following information:

For your own personal reference, fill in the spaces provided below.

Model Number of Unit _____

Serial Number of Unit _____

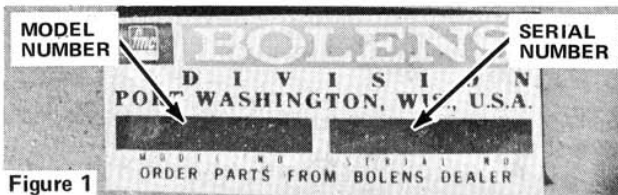

Figure 1

Your Bolens dealer has available a master Parts List for your unit. He can identify any parts you may require and furnish genuine factory replacements.

ASSEMBLY

This mower is shipped complete with all parts required to mount it to your Husky tractor. To facilitate packaging requirements, the mounting linkage has been shipped loose and must be assembled to the mower as follows:

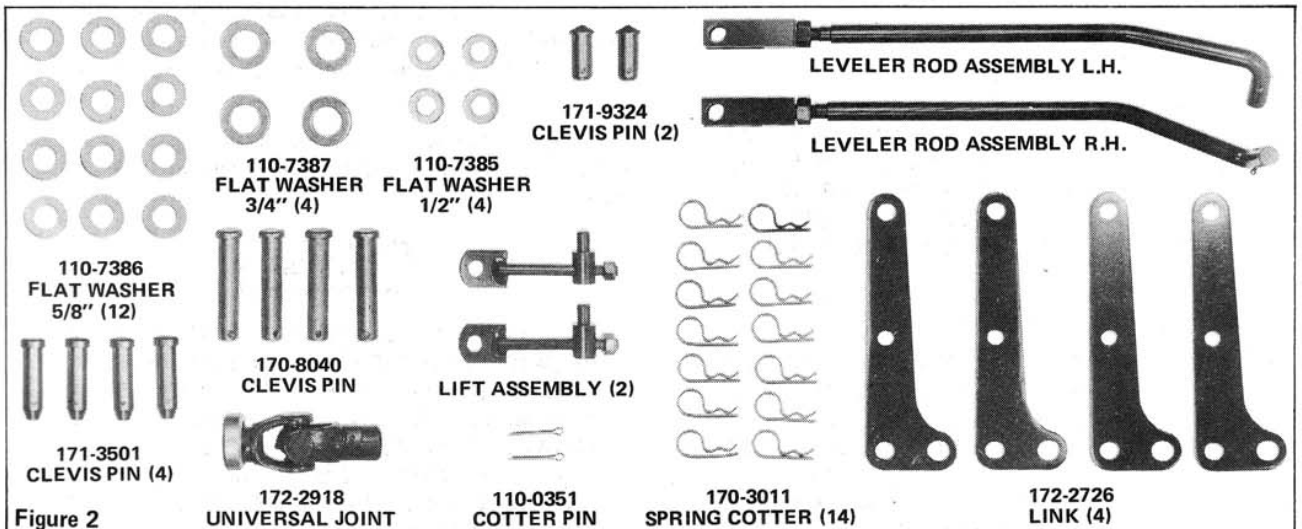

Figure 2

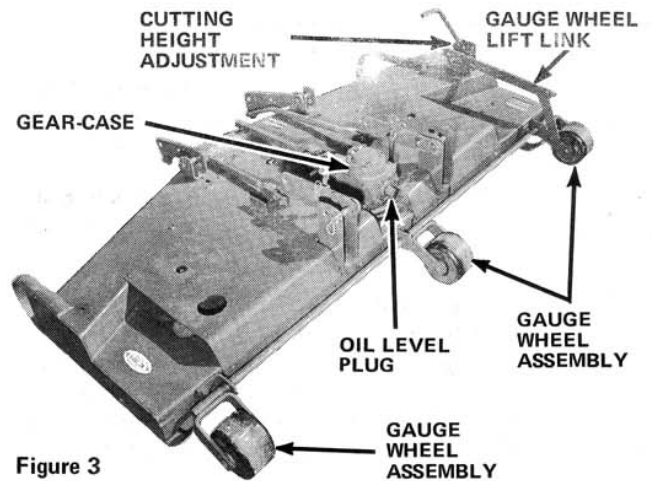

Figure 3

A. Attach lift links, figure 6, onto rear mower base lift brackets from the inside out, using flat washer, spring cotters, and clevis pins.

B. To these rear lift links, attach the two adjusted lift links, figure 6, from the inside out, using flat washers and spring cotters.

C. Attach remaining two lift links, figure 6, to front mower base lift brackets from inside out, using flat washers, spring cotters, and clevis pins.

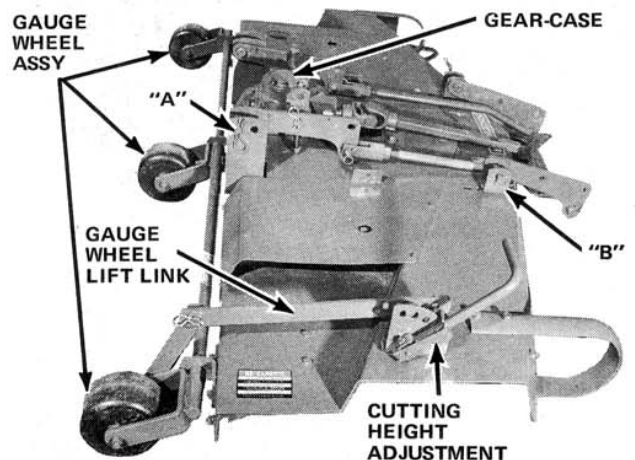

Figure 4

MOUNTING

1. With tractor on a level surface, check tire pressure, 8 lbs. front and rear. Turn tractor front wheels to extreme left. Slide mower under tractor from RIGHT HAND side.
2. Place a 3/4" or 1" board under right and left hand mower runners to elevate mower for leveling purposes fore and aft.
3. Pin mower rear hitch arms (through top hole) to the OUTSIDE of tractor rear hitch supports "A," figure 5, located just forward of the tractor hydraulic lift arms on the inside of main frame. Use clevis pins, flat washer and spring cotters, inserting clevis pins from outside in, flat washer to the inside between support and spring cotter.

NOTE

BE SURE LIFT LINK PIN IS INSTALLED INTO REAR HOLE OF REAR MOWER HITCH BRACKET; SEE "A" FIGURE 4. BE SURE FRONT MOWER HITCH BRACKET IS INSTALLED IN FRONT SET OF MOUNTING HOLES ON THE MOWER DECK; SEE "B" FIGURE 4.

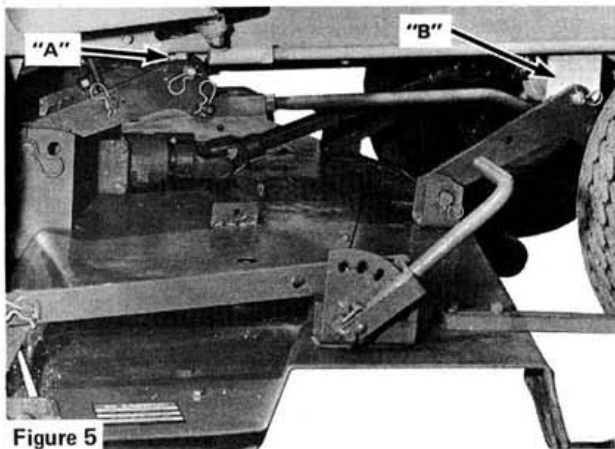

Figure 5

4. Pin mower front hitch arms (through top hole) to the OUTSIDE of tractor front hitch supports "B," figure 5, located approximately six inches behind the front axle. Use clevis pins and spring cotters, inserting clevis pins from outside in.

NOTE

IT IS IMPORTANT THAT THE FRONT AND REAR MOWER ARMS ARE MOUNTED ON THE OUTSIDE OF THE TRACTOR FRONT HITCH SUPPORTS, AS STATED ABOVE, TO ALLOW FREE MOVEMENT OF THE MOWER AT ALL TIMES.

NOTE

A SLIGHT BINDING IN FRONT AND REAR HITCH ARMS MAY OCCUR DUE TO MANUFACTURING TOLERANCES, AFTER THE INITIAL HOOK-UP HAS BEEN MADE. ADJUST FRONT MOWER LIFT BRACKETS IN SLOTTED HOLES PROVIDED FOR FREE MOVEMENT OF LIFT ARMS. THEN TIGHTEN BRACKETS SECURELY.

5. Attach leveler rods, figure 6, (hook end forward and down) to lower hole in front hitch arms from inside out with flat washer on both sides of hitch arms, and secure with cotter pins.

NOTE

BE SURE TO MOUNT LEVELER RODS; TURN BUCKLES TO THE REAR; FRONT SECTION OR ROD BEND DOWN APPROXIMATELY 6" FROM THE FRONT HOOK END. ADJUST TURN BUCKLES SO THAT LEVELER RODS ARE AS SHORT AS POSSIBLE AND THAT HOLES IN BUCKLES ALIGN WITH LOWER HOLES IN REAR HITCH ARMS. SECURE WITH CLEVIS PINS AND SPRING COTTERS. INSERT CLEVIS PINS FROM OUTSIDE IN.

6. Place tractor selector lever in PARK position, start tractor engine and move hydraulic lift lever in Down position until front section of lift arms are in their lowest position. Allow hydraulic lift control lever to return to Neutral and stop engine.

7. Position stop nuts on lift links flush with bottom of lift link studs.

8. Insert flat offset section on lift link over half inch pins (integral to tractor lift arms), and secure with flat washer and spring cotter. Install free floating stud of lift link into mower lift arms and secure with flat washer and spring cotter.

9. Start engine; place lift lever in *FLOAT POSITION*; observe position of stop nuts, and adjust so both nuts are directly under mower lift link studs. This adjustment will give maximum below ground level float. Should a higher maximum lift be desired, turn both stop nuts the same number of turns up on the studs until desired height is obtained.

10. Depress lock collar on universal joint and slide over rear splined end of tractor P.T.O. shaft. Slide universal joint onto P.T.O. shaft until lock collar snaps into groove in shaft, locking it on. Grease shaft of mower universal drive and insert into free end of universal joint on P.T.O.

If front wheels strike mower when turning, adjust turning radius as directed in your tractor manual under adjustments.

CAUTION

BE SURE ATTACHMENT IS COMPLETELY HOOKED UP BEFORE USING HYDRAULIC LIFT, OR DAMAGE COULD RESULT. MOVE THE ATTACHMENT THROUGH ITS COMPLETE RANGE SLOWLY TO MAKE SURE IT DOES NOT INTERFERE OR BIND. MAKE NECESSARY CORRECTIONS OR ADJUSTMENTS REQUIRED BEFORE OPERATING.

OPERATION

CAUTION

BEFORE USING MOWER, REMOVE STONES, WIRE, ETC. FROM AREA TO BE MOWED. BE SURE TO AVOID STRIKING PROTRUDING OBJECTS SUCH AS PIPES, ROOTS AND EARTH MOUNDS WITH CUTTING BLADES AS THIS COULD DAMAGE THE MOWER. NEVER PLACE HANDS OR FEET UNDER MOWER BASE WHEN ENGINE IS RUNNING.

Be sure the P.T.O. is disengaged and the tractor selector lever is in the PARK position before starting the engine. For best results, the engine should be set at full throttle and locked in this position to maintain sufficient blade speed. The ground speed should be controlled with the tractor Travel Pedal and not by changing engine speed. When operating under heavy load, listen to the engine R.P.M. As the engine begins to strain, let up on the Travel Pedal accordingly (DO NOT ADVANCE TRAVEL PEDAL). By letting up on the Travel Pedal, the ground speed will decrease and the engine speed will increase to allow the blade speed to remain constant.

NOTE

THE MOWER WILL NOT CUT CLEAN WHEN THE GROUND SPEED IS TOO HIGH OR WHEN THE BLADE SPEED DROPS DUE TO OVERLOAD.

CONTROLS

There are two controls for operating the mower: the tractor power take-off lever for engaging and disengaging the mower, and the tractor hydraulic lift lever to raise and lower the mower. The power take-off lever must be engaged slowly to start the mower and prevent premature belt failure.

NOTE

ALWAYS START MOWER BEFORE LOWERING MOWER INTO THE GRASS.

HEIGHT OF CUT

The cutting height can be regulated by the hydraulic lift lever or the mower gauge wheels, and ranges from a low of approximately 1-1/2" to a high of approximately 5". When using the mower gauge wheels to regulate the cutting heights, always place the hydraulic lift lever in the FLOAT POSITION to allow mower to ride freely over rough terrain.

In areas where use of the gauge wheels is not desired, they may be raised to clear the ground by relocating the gauge wheel lift link, to the rear hole on the forward end attached to the gauge wheel lift arm; and then raising wheels to their maximum height. The height of cut can then be regulated through the hydraulic lift lever.

NOTE

WHEN MOWER GAUGE WHEELS ARE NOT BEING USED, HYDRAULIC LIFT LEVER MUST NOT BE PLACED IN THE FLOAT POSITION. MOWER IS TO BE LOWERED ONLY AS FAR AS NECESSARY, THEN ALLOW LIFT CONTROL LEVER TO GO BACK TO NEUTRAL, TO HOLD MOWER AT THE DESIRED HEIGHT.

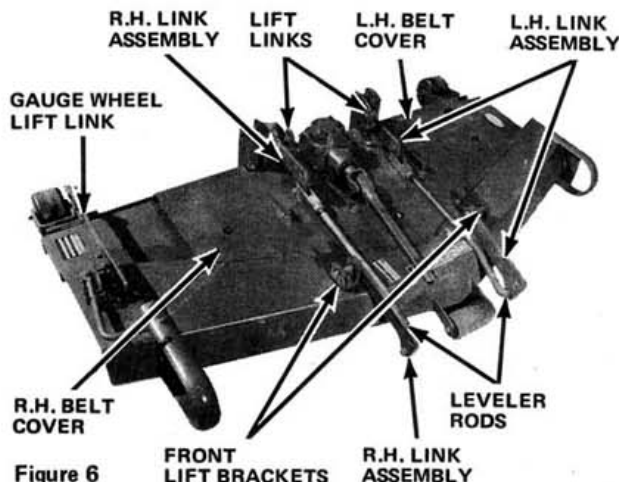

NOTE

WHEN MOWING WITH MOWER IN HIGH CUTTING POSITIONS, AVOID TERRAIN WHICH COULD CAUSE THE WEIGHT OF THE TRACTOR TO RIDE ON MOWER CAUSING POSSIBLE DAMAGE TO THE MOWER.

WARNING

AT NO TIME SHOULD MOWER BE OPERATED WITH ANTI-SCALP RUNNERS OR ROLLER IN CONSTANT CONTACT WITH THE GROUND. THIS PRACTICE WOULD LEAD TO PREMATURE MOWER FAILURE DUE TO SEVERE SHOCK-LOADING.

DRIVE BELT

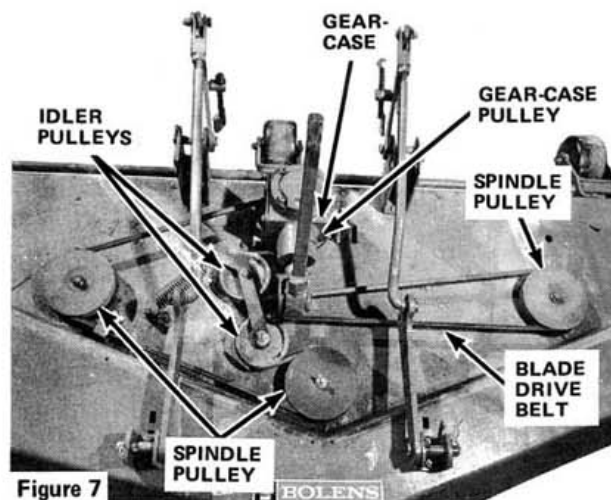

The mower has one drive belt which drives the three blades, as illustrated in figure 7. This belt is under constant spring tension and requires no adjustment.

To replace the drive belt, proceed as follows:

- A. Remove mower from tractor.
- B. Remove the Left and Right hand covers from the mower deck and the Left hand mower gear case mounting bracket.
- C. Remove belt from blade spindle and idler pulleys, and slip off over top of gear case.
- D. Replace belt by reversing the above procedure.

CUTTING BLADES

For efficient cutting, maintain sharp cutting edges on the blades at all times. When sharpening blades, be sure to grind or file equal portions off both ends to maintain balance, as an unbalanced blade will cause excessive vibration and ultimately premature failure. Always check blades on a blade balancer before reinstallation.

NOTE

WHEN REPLACING OR REINSTALLING ORIGINAL BLADES AFTER SHARPENING, BE SURE THE 5/16-18 x 3/4 HEX HEAD CAPSCREWS AND LOCKNUTS ARE ALSO REINSTALLED IN THE BLADE HUBS. BE SURE THE BLADES ARE FASTENED SECURELY AT ALL TIMES. TORQUE CAPSCREWS TO 300 INCH-LBS. RECHECK PERIODICALLY.

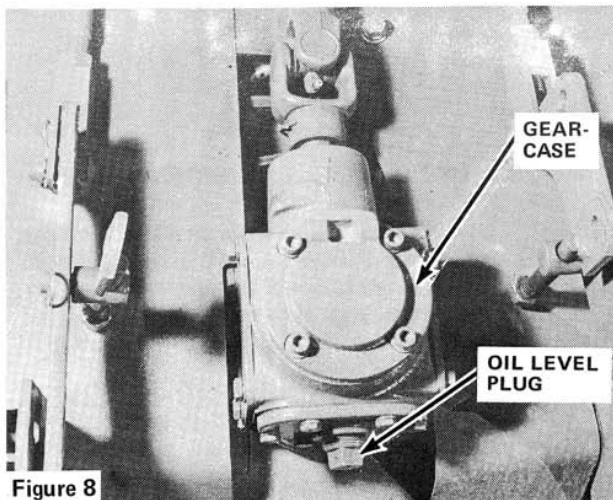

Figure 8

LUBRICATION

The unit has five grease fittings: one on each blade spindle located on the top side of the mower deck; one on each universal joint. Lubricate grease fittings every 8 hours of operation, one stroke per fitting. Oil all linkage and anti-scalp roller at periodic intervals.

NOTE

THE GEAR CASE IS FILLED AT THE FACTORY WITH 11 OZ. OF SAE 90 GEAR OIL. REMOVE PLUG AT REAR OF GEAR CASE, FIGURE 8. CHECK OIL LEVEL — OIL SHOULD BE TO THE LEVEL OF THE PLUG OPENING — BEFORE RUNNING MOWER AND AT INTERVALS OF EVERY 6 TO 8 HOURS OF OPERATION TO MAINTAIN PLUG LEVEL.

Bolens reserves the right to change specifications, add improvements or discontinue the manufacture of any of its equipment without notice or obligation to purchasers of its equipment when equipment was purchased prior to decision to make changes, add improvements or discontinue manufacture.

Bolens' approval of the use of attachments manufactured by other manufacturers is limited to assurance that such use will not void Bolens warranty on the Bolens equipment to which the outside manufactured attachments are adapted. The responsibility for the design, performance, durability, safety in operation, service repair availability, and warranty obligation remain with the outside manufacturer. Bolens specifically excludes from its warranty obligation all such outside manufactured attachments.

Bolens warranty will be voided if unapproved attachments are adapted to use with Bolens equipment and are so used.



BOLENS

PORT WASHINGTON WISCONSIN, U.S.A.

PRINTED IN U.S.A.

ILLUSTRATED PARTS LIST

BOLENS

54 INCH CENTER MOUNTED
ROTARY MOWER
ATTACHMENT
MODEL 18070-02

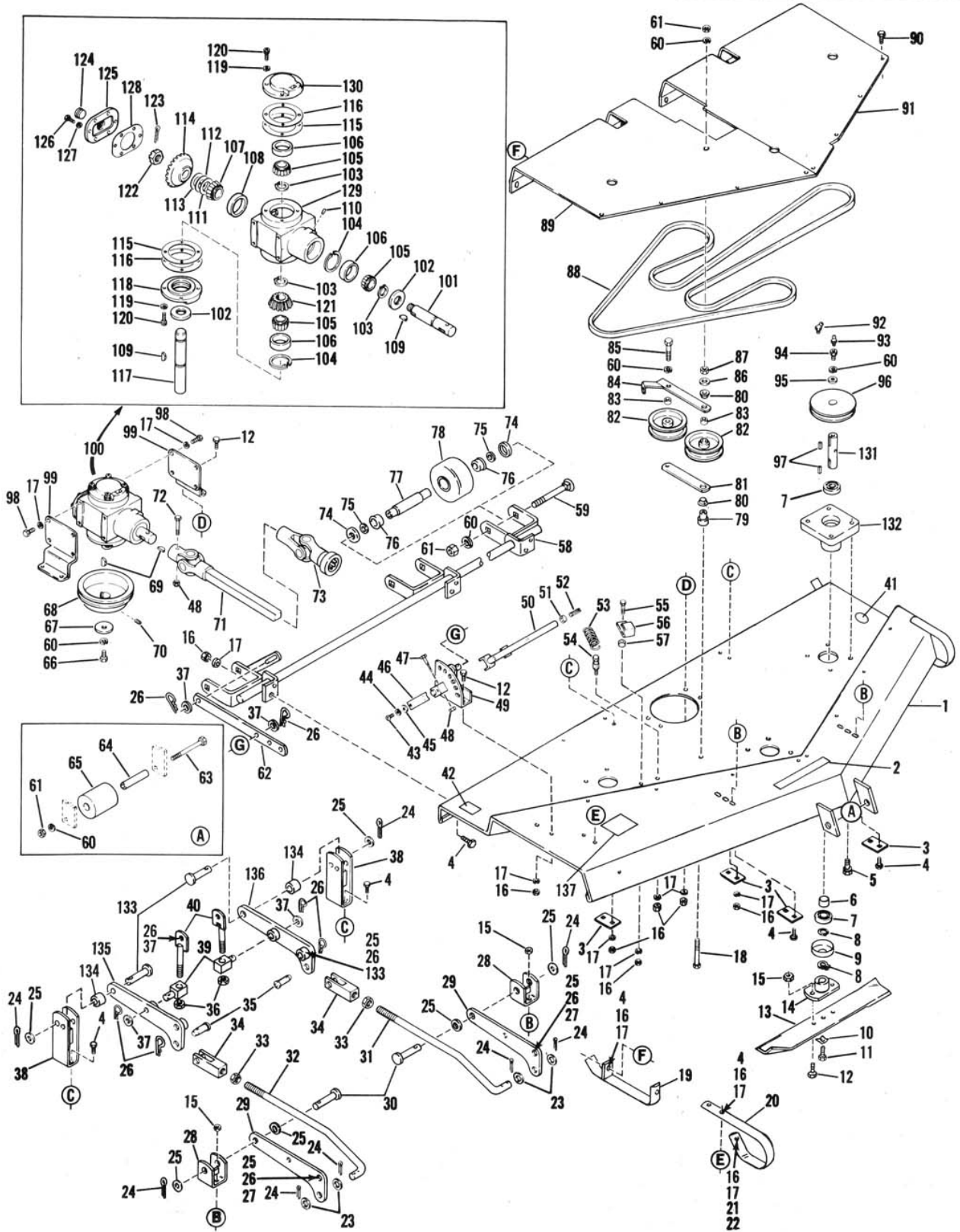

PRINTED IN U.S.A.

FORM NO. P-552495 12/71

ROTARY MOWER MODEL 18070-02

Ref. No.	Part No.	Description	No. Req'd.	Ref. No.	Part No.	Description	No. Req'd.
1	1722 912	Base Assembly	1	69	1100 276	Woodruff Key, 1/4x7/8	2
2	1715 633	Decal (Bolens)	1	70	1103 466	Set Screw, 5/16-18x3/8	2
3	1720 372	Support Plate	4	*71	1722 632	Drive Assembly	1
4	1106 876	Capscrew, 5/16-18x7/8	18	72	1106 849	Capscrew, 1/4-20 x 1-3/4	1
5	1185 670	Capscrew, 5/16-18x7/8 with Lockwasher	12	*73	1722 918	Universal Joint Assy.	1
6	1720 999	Spacer	3	74	1894 386	Cupped Washer	6
7	1185 828	Ball Bearing	6	75	1705 108	Flat Washer	6
8	1185 708	Retaining Ring	6	76	1185 695	Ball Bearing	6
9	1716 744	Cap	3	77	1717 737	Bearing Axle	3
10	1185 715	Lockwasher, 3/8 (Pyramidal Type)	3	78	1717 649	Roller	3
11	1100 009	Capscrew, 3/8-24 x 1	3	79	1722 884	Idler Spacer	1
12	1106 874	Capscrew, 5/16-18 x 3/4	12	80	1714 299	Nylon Bushing	2
13	1722 883	Cutter Blade	3	81	1718 649	Idler Arm	1
14	1722 882	Hub Assembly	3	82	1724 488	Idler Pulley	2
15	1110 107	Lock Nut, 5/16-18	10	83	1718 651	Spacer	2
16	1182 563	Hex Nut, 5/16-18	23	84	1718 642	Idler Arm Assembly	1
17	1100 242	Lockwasher, 5/16	31	85	1107 249	Capscrew, 3/8-24 x 1-3/4	1
18	1106 940	Capscrew, 3/8-16 x 3	1	86	1100 265	Flat Washer	1
19	1722 899	Rear Runner Assy.	1	87	1121 551	Jam Nut, 3/8-16	1
20	1722 896	Right Hand Runner	1	88	1718 653	V-Belt	1
21	1106 878	Capscrew, 5/16-18 x 1	1	89	1722 903	Right Hand Belt Cover	1
22	1803 327	Flat Washer, 5/16	1	90	1185 712	Self Thread Screw, #10-20 x 1/2	17
23	1107 387	Flat Washer, 3/8	4	91	1722 902	Left Hand Belt Cover	1
24	1100 351	Cotter Pin, 1/8 x 1-1/4	8	92	1110 086	Grease Fitting, 45°	1
25	1107 386	Flat Washer, 5/8	12	93	1104 954	Grease Fitting	1
26	1723 478	Spring Cotter	12	94	1719 331	Bolt	3
27	1713 501	Clevis Pin	2	95	1701 055	Flat Washer	3
28	1722 947	Lift Bracket Assy., Front	2	96	1722 886	Pulley	3
29	1722 726	Right Hand Link	2	97	1108 852	Square Key, 3/16 x 3/4	6
30	1708 040	Clevis Pin	2	98	1106 872	Capscrew, 5/16-18x5/8	8
31	1722 805	Left Hand Rod	1	99	1722 901	Support Bracket	2
32	1722 806	Right Hand Rod	1	100	1718 650	Gear Box Assembly	1
33	1121 513	Hex Nut, 5/8-11	2	101	1718 622	Input Shaft	1
34	1714 573	Rod End	2	102	1185 687	Oil Seal	2
35	1719 324	Clevis Pin	2	103	1185 689	Retaining Ring	3
36	1110 110	Lock Nut, 1/2-13	2	104	1118 735	Retaining Ring	2
37	1107 385	Flat Washer, 1/2	6	105	1185 661	Bearing Cone	3
38	1722 720	Rear Lift Bracket Assy.	2	106	1185 660	Bearing Cup	3
39	1724 316	Stud	2	107	1185 688	Bearing Cone	1
40	1715 404	Link Assembly	2	108	1185 118	Bearing Cup	1
41	1722 725	Decal (Caution)	1	109	1709 611	Woodruff Key, 1/4 x 7/8	2
42	1715 670	Decal (Caution)	1	110	182 682	Breather	1
43	1114 748	Machine Screw, #10-32 x 1/2	1	111	1800 750	Shim, 1-1/2 x .003	1
44	1100 240	Lockwasher, #10	1	112	1800 751	Shim, 1-1/2 x .005	1
45	1103 959	Flat Washer, #10	1	113	1800 338	Shim, .015	1
46	1718 655	Spring	1	114	1717 459	Gear, 29T	1
47	1106 847	Capscrew, 1/4-20 x 1-1/2	1	115	1717 456	Gasket	10
48	1110 106	Lock Nut, 1/4-20	2	116	1719 501	Gasket	2
49	1718 667	Quadrant Assembly	1	117	1718 621	Shaft, Output	1
50	1718 664	Handle Assembly	1	118	1717 454	Bearing Retainer	1
51	1719 328	Spacer	1	119	1100 242	Lockwasher, 5/16	8
52	1185 400	Roll Pin, 5/16 x 1-1/4	1	120	1185 686	Capscrew, 5/16-18 x 3/4	8
53	1706 822	Extension Spring	1	121	1717 457	Bevel Pinion, 18T	1
54	1715 210	Spring Anchor Bolt	1	122	1185 662	Slotted Nut, 7/8 - 14 UNF	1
55	1106 884	Capscrew, 5/16-18 x	1	123	1100 352	Cotter Pin, 1/8 x 1-1/2	1
56	1719 338	Belt Guide	1	124	1185 685	Plug, 3/4 - 14NPT	1
57	1722 948	Spacer	1	125	1717 448	Cover	1
58	1722 894	Wheel Yoke Assembly	1	126	1185 684	Capscrew, 1/4-20 x 5/8	6
59	1111 293	Carr. Bolt, 3/8-16 x 4-1/2	3	127	1100 241	Lockwasher, 1/4	6
60	1100 243	Lockwasher, 3/8	10	128	1717 449	Gasket Cover	1
61	1121 509	Hex Nut, 3/8-16	5	129	1719 710	Gear Case (Incl. Nos. 107, 108, 111, 112 and 113)	1
62	1722 888	Lift Link	1	130	1718 620	Bearing Retainer	1
63	1106 958	Capscrew, 3/8-16 x 6	1	131	1722 887	Drive Shaft	3
64	1720 578	Spacer	1	132	1722 865	Bearing Housing	3
65	1720 577	Roller	1	133	1718 772	Clevis Pin	4
66	1111 708	Capscrew, 3/8-24 x 5/8	1	134	1718 555	Tubular Spacer	2
67	1703 052	Flat Washer	1	135	1724 317	Right Hand Link	1
68	1718 659	Sheave	1	136	1724 318	Left Hand Link	1
				137	1723 109	Decal (Cutting Hgt. Adj.)	1

*1714 207 Repair Kit for Joint Marked 6N

*1714 208 Repair Kit for Joint Marked NEAPCO

PRINTED IN U.S.A.

FORM NO. P-552495 12/71