

ILLUSTRATED PARTS LIST

BOLENS

MODEL 18457-02

&

MODEL 18458

WHEEL KIT

42 INCH CENTER MOUNTED
ROTARY MOWER ATTACHMENT

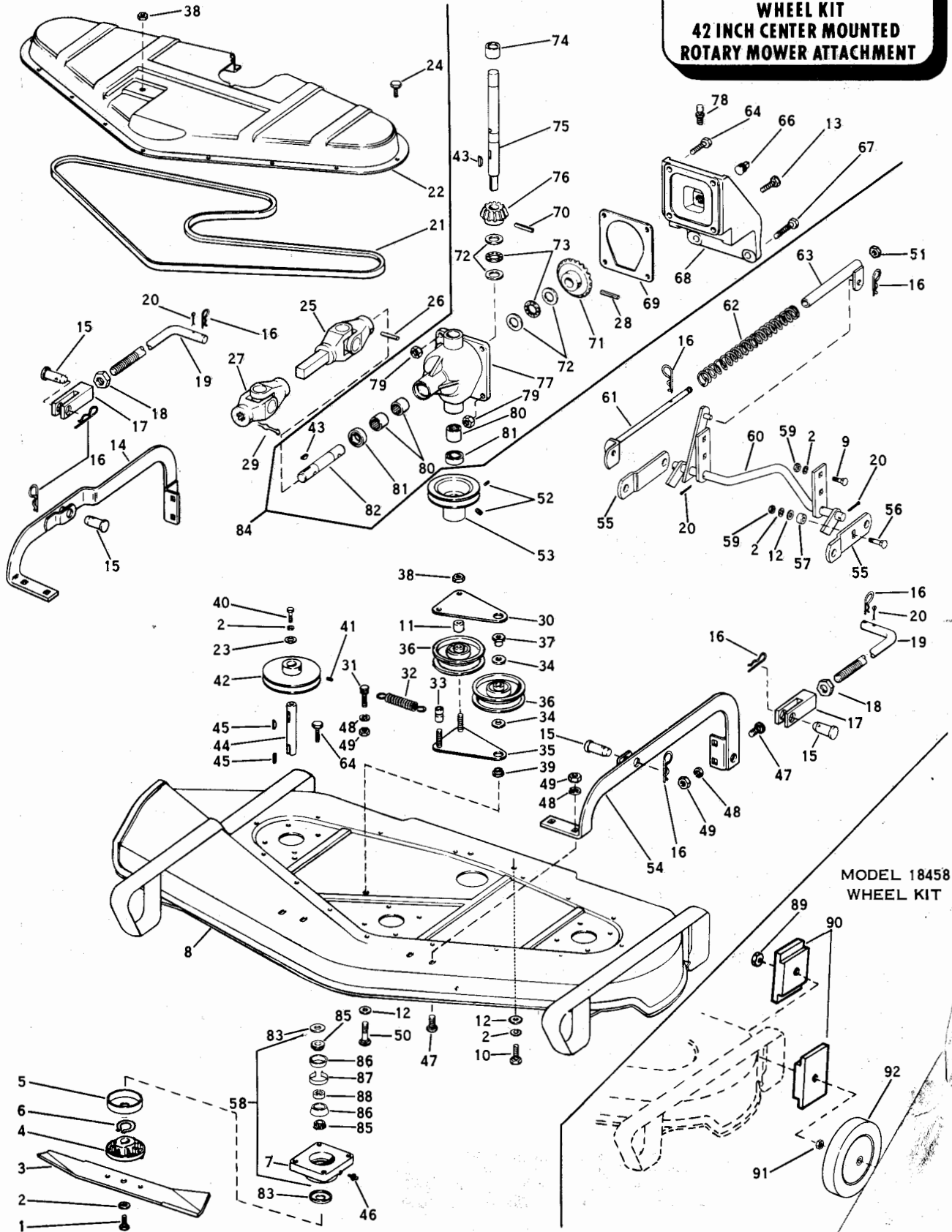

PRICE: ONE DOLLAR

FORM NO. P-1
SUPERSEDES

ROTARY MOWER MODEL 18457-02

| Ref. No. | Part No. | Description | No. Req'd. |
|----------|----------|-----------------------------|------------|
| 1 | 1100009 | Capscrew - H.T. | 3 |
| 2 | 1100243 | Lockwasher 3/8 | 11 |
| 3 | 1717251 | Mower Blade | 3 |
| 4 | 1716745 | Drive Hub | 3 |
| 5 | 1716744 | Cap | 3 |
| 6 | 1185708 | Retaining Ring | 3 |
| 7 | 1716747 | Bearing Housing | 3 |
| 8 | 1716751 | Base | 1 |
| 9 | 1111285 | Carriage Bolt 3/8-16 x 1 | 4 |
| 10 | 1106919 | Capscrew 3/8-16 x 1 | 2 |
| 11 | 1716778 | Spacer | 1 |
| 12 | 1107383 | Flat Washer 3/8 | 8 |
| 13 | 1106896 | Capscrew 5/16-18 x 2-3/4 | 2 |
| 14 | 1718095 | Bail - R.H. | 1 |
| 15 | 1713553 | Clevis Pin | 4 |
| 16 | 1703011 | Spring Cotter | 8 |
| 17 | 1714573 | Rod End | 2 |
| 18 | 1108891 | Jam Nut 5/8-11 | 2 |
| 19 | 1716890 | Link Rod | 2 |
| 20 | 1100350 | Cotter Pin 1/8 x 1 | 6 |
| 21 | 1185651 | Drive Belt - 114-5/32" | 1 |
| 22 | 1716752 | Belt Cover | 1 |
| 23 | 1708755 | Washer | 3 |
| 24 | 1185671 | Capscrew 1/4-20 x 1/2 | 15 |
| *25 | 1714728 | Universal Joint & Shaft | 1 |
| 26 | 1185220 | Roll Pin 3/16 x 1-1/2 | 1 |
| *27 | 1715008 | Universal Joint | 1 |
| 28 | 1185284 | Roll Pin 1/4 x 2 | 1 |
| 29 | 1716369 | Cotter Pin - Special | 1 |
| 30 | 1716760 | Idler Arm | 1 |
| 31 | 1715210 | Anchor Bolt | 1 |
| 32 | 1716777 | Spring | 1 |
| 33 | 1716779 | Spacer | 1 |
| 34 | 1714233 | Bearing | 2 |
| 35 | 1716759 | Idler Arm | 1 |
| 36 | 1714742 | Idler Pulley | 2 |
| 37 | 1716775 | Nut - Special | 1 |
| 38 | 1185506 | Jam Nut 3/8-16 | 3 |
| 39 | 1716776 | Spacer | 1 |
| 40 | 1111708 | Capscrew 3/8-24 x 5/8 | 3 |
| 41 | 1103466 | Set Screw 5/16-18 x 3/8 | 6 |
| 42 | 1716763 | Blade Drive Pulley | 3 |
| 43 | 1104436 | Woodruff Key 3/16 x 3/4 | 2 |
| 44 | 1718097 | Drive Shaft | 3 |
| 45 | 1108852 | Sq. Key 3/16 x 3/4 | 6 |
| 46 | 1110086 | Grease Fitting | 3 |
| 47 | 1111265 | Carriage Bolt 5/16-18 x 3/4 | 8 |
| 48 | 1100242 | Lockwasher 5/16 | 9 |

| Ref. No. | Part No. | Description | No. Req'd. |
|----------|----------|---------------------------|------------|
| 49 | 1103839 | Hex Nut 5/16-18 | 9 |
| 50 | 1106934 | Capscrew 3/8-16 x 2-1/4 | 1 |
| 51 | 1110108 | Lock Nut 3/8-16 | 1 |
| 52 | 1103490 | Set Screw 3/8-16 x 3/8 | 2 |
| 53 | 1716749 | Pulley | 1 |
| 54 | 1716770 | Bail - L.H. | 1 |
| 55 | 1718085 | Adjusting Arm | 2 |
| 56 | 1111286 | Carr. Bolt 3/8-16 x 1-1/4 | 2 |
| 57 | 1718080 | Spacer | 2 |
| 58 | 1716949 | Housing & Bearing Assy. | 3 |
| 59 | 1103840 | Hex Nut 3/8-16 | 8 |
| 60 | 1718083 | Lift Arm | 1 |
| 61 | 1714868 | Guide Rod | 1 |
| 62 | 1716774 | Spring | 1 |
| 63 | 1714871 | Tube | 1 |
| 64 | 1185670 | Capscrew 5/16-18 x 7/8 | 12 |
| 65 | 1106882 | Capscrew 5/16-18 x 1-1/4 | 2 |
| 66 | 1105678 | Plug | 1 |
| 67 | 1106927 | Capscrew 3/8-16 x 1-1/2 | 2 |
| 68 | 1716767 | Gear Case Support | 1 |
| 69 | 1713662 | Gasket | 1 |
| 70 | 1185348 | Roll Pin 1/4 x 1-1/4 | 1 |
| 71 | 1715634 | Gear - 19T | 1 |
| 72 | 1185432 | Thrust Race | 4 |
| 73 | 1185431 | Thrust Bearing | 2 |
| 74 | 1713665 | Needle Bearing | 1 |
| 75 | 1714754 | Vertical Shaft | 1 |
| 76 | 1715635 | Gear - 16T | 1 |
| 77 | 1716345 | Gear Case Only | 1 |
| 78 | 1185626 | Air Vent Fitting | 1 |
| 79 | 1110107 | Locknut 5/16-18 | 4 |
| 80 | 1185010 | Needle Bearing | 3 |
| 81 | 1185296 | Seal | 2 |
| 82 | 1713676 | Horizontal Shaft | 1 |
| 83 | 1185648 | Seal | 6 |
| 84 | 1716773 | Complete Gear Case Assy | |
| 85 | 1185275 | Bearing Cone | 6 |
| 86 | 1185276 | Bearing Cup | 6 |
| 87 | 1718706 | Cup Spacer Ring | 3 |
| 88 | 1718707 | Cone Spacer Ring | 3 |

WHEEL KIT MODEL 18458

| | | | |
|----|---------|-------------------------------|---|
| 89 | 1110110 | Nut - Self Locking 1/2-13 | 2 |
| 90 | 1716791 | Clamp-Wheel Support | 4 |
| 91 | 1185496 | Nut - Self Locking Jam 1/2-13 | 2 |
| 92 | 1716793 | Wheel - 5" Dia. | 2 |
| 93 | 1716792 | Bolt - Special 1/2-13 x 3-3/4 | 2 |

* 1714207 Repair Kit for Joint Marked 6N

* 1714208 Repair Kit for Joint Marked NEAPCO



BOLENS

PORT WASHINGTON WISCONSIN, U.S.A.