



Ingersoll

**HYDRAULIC PTO KIT
HP34**

Operator's Manual 8-59240

casecoltingersoll.com

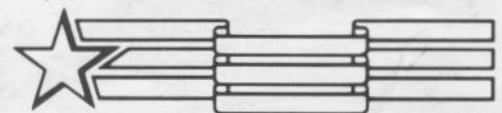

QUALITY IN THE AMERICAN TRADITION

Printed in U.S.A.

Ingersoll Equipment Co., Inc.

Winneconne, Wisconsin 54986-9576



This Safety Alert Symbol Indicates Important Safety Messages In This Manual When You See This Symbol Carefully Read The Message That Follows and Be Alert To The Possibility Of Personal Injury Or Death

IF THIS MACHINE IS USED BY AN EMPLOYEE OR IS LOANED OR RENTED, MAKE ABSOLUTELY CERTAIN THAT THE OPERATOR(S), PRIOR TO OPERATING:

1. IS INSTRUCTED IN SAFE AND PROPER USE.
2. REVIEWS AND UNDERSTANDS THE MANUAL(S) PERTAINING TO THE MACHINE.

751253



WARNING

BEFORE STARTING ENGINE

STUDY OPERATOR'S MANUAL SAFETY MESSAGES
READ ALL SAFETY SIGNS ON MACHINE
CLEAR THE AREA OF OTHER PERSONS

LEARN & PRACTICE SAFE USE OF CONTROLS BEFORE OPERATING

IT IS YOUR RESPONSIBILITY TO UNDERSTAND AND FOLLOW MANUFACTURER'S INSTRUCTIONS ON MACHINE OPERATION, SERVICE AND TO OBSERVE PERTINENT LAWS AND REGULATIONS. OPERATOR AND SERVICE MANUALS MAY BE OBTAINED FROM YOUR EQUIPMENT DEALER.

SAFETY RULES

CAUTION: Hydraulic systems are highly pressurized. Escaping hydraulic oil, even an invisible pinhole leak, can penetrate body tissues causing serious injury. Use a piece of wood or cardboard when looking for leaks - never use the hands or other parts of the body.

Relieve hydraulic pressure before disconnecting circuits. When reassembling, make absolutely certain that all connections are tight.

If injured by hydraulic oil escaping under pressure, see a doctor immediately. Serious complications may arise if medical attention is not given at once.

Remember, a careful operator is always the best insurance against an accident.

Always give complete and undivided attention to the job at hand.

CAUTION: Only operate controls while in the operator's position. Do not operate the machine while under the influence of alcohol or drugs.

WARNING: Be sure the Hydraulic PTO lever is in the neutral position before starting the tractor.

IMPORTANT: Always install new decals whenever the old decals are destroyed, lost, painted over or illegible. When individual parts are replaced that have decals attached, be sure to install a new decal with the new part. Decals are available from your authorized dealer.

TABLE OF CONTENTS

	Page
SAFETY RULES	2
INTRODUCTION	3
PREPARATION	3
INSTALLATION	4-6
OPERATION	6
MAINTENANCE	6

INTRODUCTION

Congratulations, your purchase of this Hydraulic PTO Kit will make your Ingersoll Hydraulic Tractor more versatile than ever. You can now operate many hydraulic attachments available from your local Ingersoll Dealer. To mention a few of the attachments available: Log Splitter, Chipper/Shredder, Tiller, Hydra Vac, Hydra Bagger, Rear Mount Mower and Hydra Cutter.

CONSULT YOUR INGERSOLL DEALER FOR DETAILS ON PRICE AND AVAILABILITY.

ASSEMBLY PROCEDURES:

PREPARATION:

NOTE: All reference to right or left is from operator's position.

1. Remove belly pan from underside of tractor.
2. Remove transaxle shift cover by removing shift lever knob, and four (4) each phillip head screws.
3. Remove screen on right side of steering tower by removing four (4) each phillip head screws.
4. Position travel lever in full forward to prevent hydraulic oil reservoir from draining.
5. Place a clean piece of plastic over hydraulic oil reservoir neck and re-install cap.

NOTE: Early production tractors did not have a clamp mounting hole in the left frame rail behind belly pan. See figure 1 and add hole if necessary.

CAUTION: DO NOT drill into hydraulic tube inside frame rail.

NOTE: Early production tractors did not have slots, or a second set of holes to allow easy mounting of work tube clamps. See figure 2 and add holes if necessary.

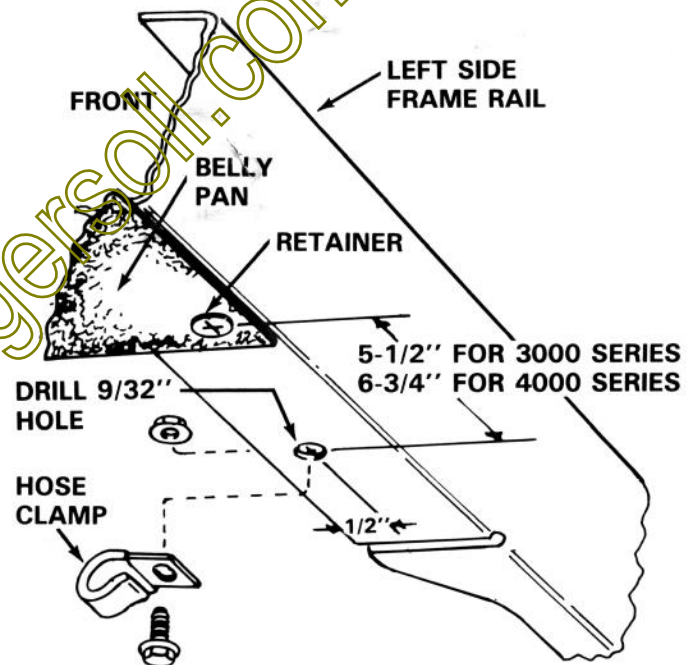

FIGURE 1



FIGURE 2

INSTALLATION

CASE DRAIN HOSE

1. Route 90° hose fitting up to cap nut fitting on hydraulic oil filter head see figure 5. Center section of hose will lay up in right side frame rail. See figure 4. Rear section of hose will cross over behind travel valve and connect to adaptor fitting (21) at rear seat support. Tighten adaptor fitting (21) to hose (22).
2. Apply tefflon tape to adaptor fitting (21) and install three (3) each belleville washers (20) as shown in figure 7.
3. Install adaptor fitting (21) through hole in rear seat support and install male quick coupler (19). DO NOT tighten at this time, fitting must be allowed to swivel.
4. Remove cap nut from fitting at hydraulic oil filter head. See figure 5 and install 90° case drain hose fitting. Position hose so it does not contact moving parts and tighten.
5. Tighten male quick coupler (19) at rear adaptor fitting (21) of case drain hose.
6. Install case drain hose clamp, bolt and nut. See figure 1. Clip hose in clamp.

PTO VALVE

1. Remove 90° fitting (26) from front seat support. See figure 7.
2. Install PTO valve (1), connecting inlet and outlet tubes loosely. Mount valve with two (2) each hex socket head screws (2) provided in kit and tighten. See figure 3.
3. Tighten PTO valve inlet and outlet connections.

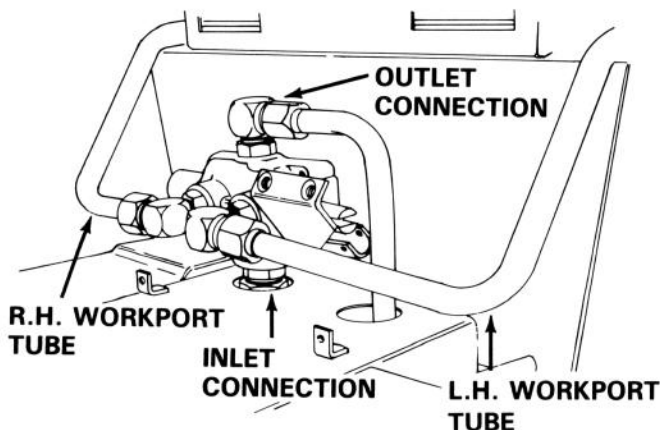

FIGURE 3

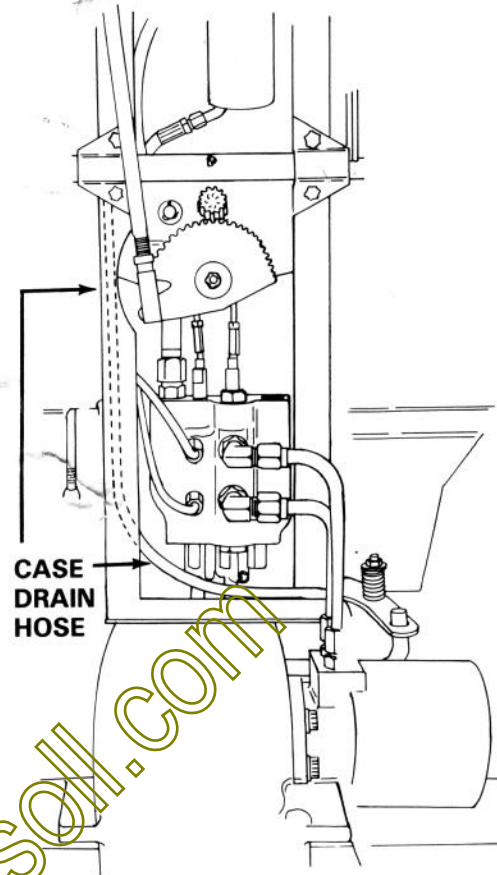

FIGURE 4

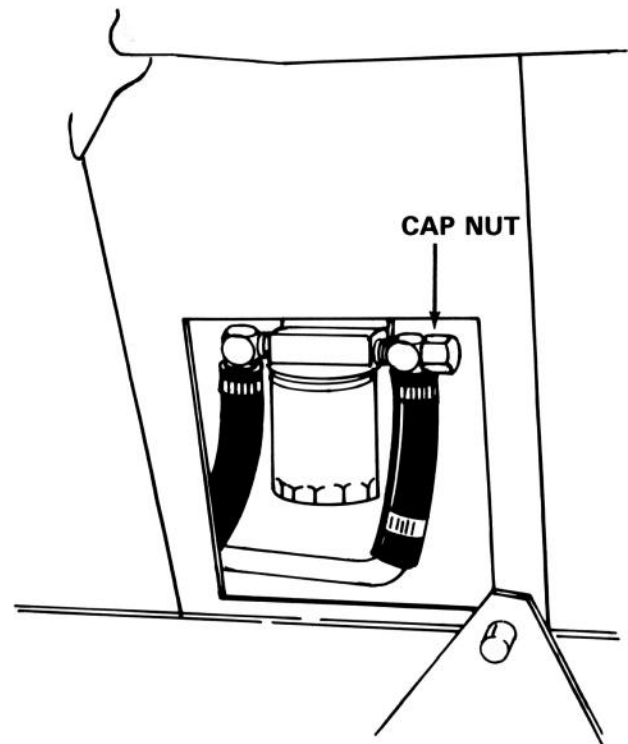

FIGURE 5

WORK-PORT TUBES

1. Install left hand work-port tube (3) to PTO valve as shown in figure 3. The tube should run parallel with the rear fender. See figure 6.
2. Install the female quick coupler (10) rubber dust plug (13), pipe nipple (7) (be sure to use teflon tape on both ends of pipe nipple) and adaptor fitting (6) to the left work port tube as shown in figure 7, tighten securely.
3. Install the tube clamp, (8) spacers and cover (11) by positioning the clamp around the pipe nipple and securing to the fender support as shown in figure 6 and 7.
4. Install right hand work-port tube (16) following steps 2 and 3 using the male quick coupler (15).
5. Tighten both work-port tubes securely. Check all valve fittings to make sure they are tight.
6. Install black plastic corrugated conduit (4) (17) on both work port tubes. Secure the conduit in place with four (4) each nylon ties (5), one at the top and one at the bottom. See figure 7.
7. Remove plastic from under reservoir cap and return travel lever to neutral.

L.H. QUICK
COUPLER (FEMALE)

R.H. QUICK
COUPLER (MALE)

TUBE CLAMP

CASE DRAIN PORT

FIGURE 6

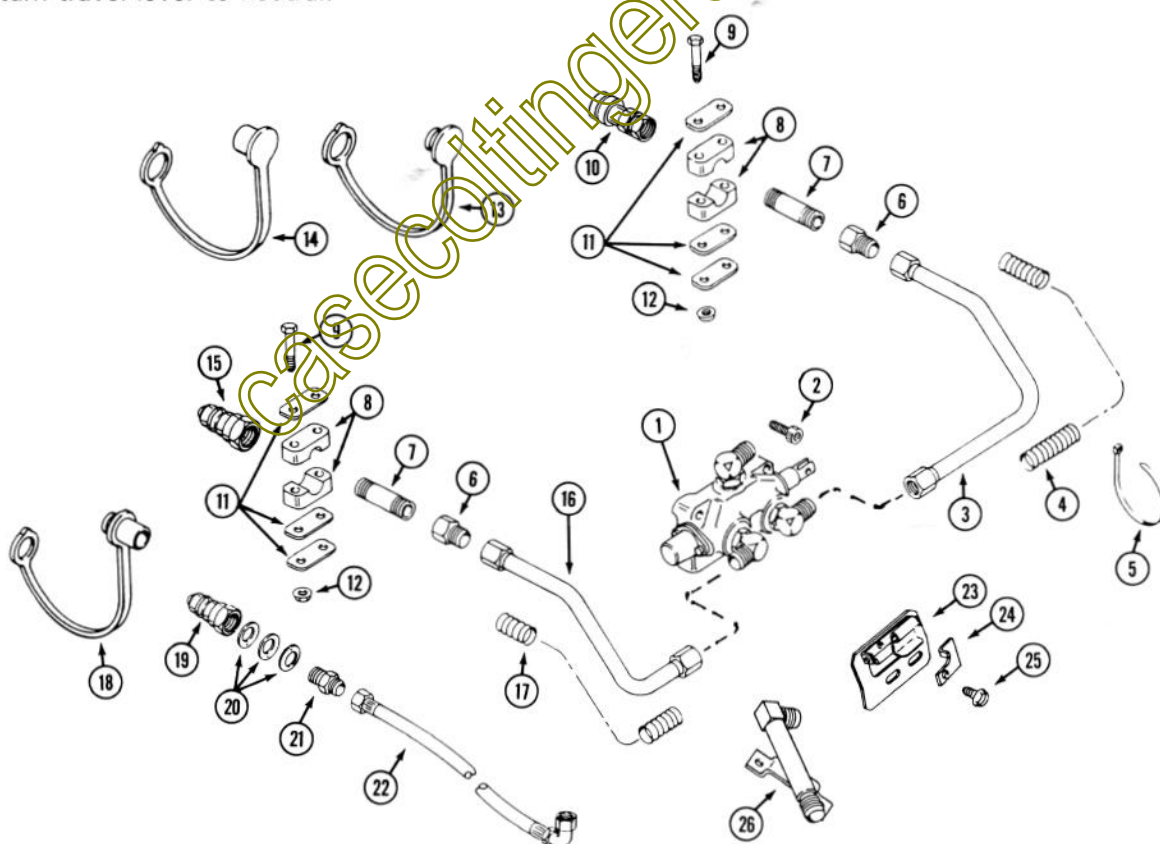

FIGURE 7

LOCKOUT PLATE

1. Remove jumper wire(s) from safety switch electrical connectors and install connectors to switches mounted to lockout plate assembly (23).

IMPORTANT: Unless PTO is being used with a tiller, the reverse lockout latch (24) must be installed. See figure 7.

2. Install the PTO lockout plate assembly (23) to the valve bracket as shown in figure 8 using two (2) each 5/16 - 18 x 1/2" hex bolts (25). (NOTE: DO NOT tighten at this time.)
3. Center the PTO lockout plate assembly with the valve lever in the neutral position and tighten. (NOTE: Make sure PTO lever will move over and up into the forward position.)
4. Remove blank from shift cover, and re-install cover with four (4) each phillip head screws removed in preparation steps. Install shift and PTO knobs.
5. Re-install screen on right side of steering tower with four (4) each phillip head screws.
6. Re-install belly pan.

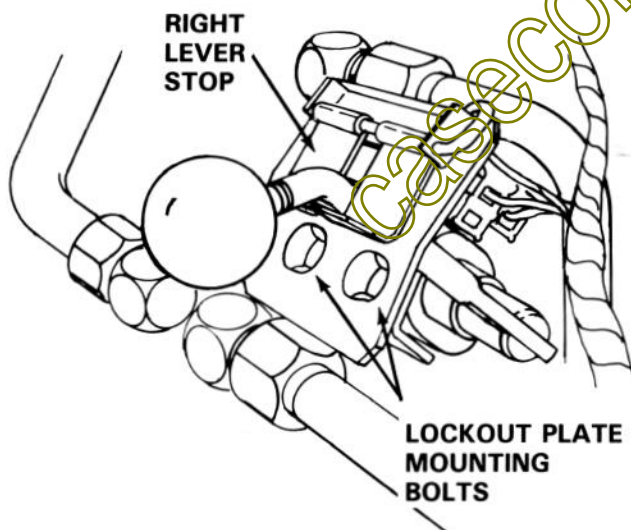

FIGURE 8

NOTE: Extra parts included.

1. If a 3 point hitch is installed with the HP34 on a 3000 series tractor, you must use the 45° fittings to provide proper clearance.
2. A hydraulic hose 1/2" ID x 56" long, male and female quick couplers have been provided for attachment hook ups.
3. Consult the attachment operators manual for hydraulic hose connections.

OPERATION:

DO NOT ENGAGE THE PTO WITHOUT A HYDRAULIC ATTACHMENT PROPERLY INSTALLED AND HOSES CONNECTED. SPIKE PRESSURES MAY OCCUR THAT COULD CAUSE PUMP DAMAGE.

CHECK TO INSURE ALL FITTINGS ARE TIGHT AND ALL WIRES ARE IN PLACE. CHECK THE HYDRAULIC FLUID LEVEL. START THE TRACTOR AND ENGAGE THE PTO AND CHECK FOR LEAKS.

(CAUTION: NEVER CHECK FOR LEAKS WITH YOUR BARE HAND. HYDRAULIC FLUID MAY BE UNDER EXTREME PRESSURE AND WILL CAUSE SEVERE INJURY. USE A PIECE OF WOOD, CARDBOARD, OR A HEAVY PAIR OF RUBBER GLOVES.)

Operate PTO while sitting on the tractor seat. (NOTE: Only operate PTO from the off seat position if your tractor is equipped with the off seat safety switch provided with the Chipper/Shredder and Log Splitter.)

1. To engage PTO; lift right LEVER STOP and slowly move the PTO LEVER to the right see figure 8. As the attachment increases in speed, continue moving the lever to the right and up until it is in the detent position. (NOTE: DO NOT move the PTO LEVER to the left unless your attachment permits reverse operation. Motor damage may occur. (Consult your attachment owners manual.)

MAINTENANCE:

Periodically check for leaks and the condition of your hoses. Always keep the quick couplers clean and install dust caps or plugs when not in use.