

Phone # 1-414-582-4455

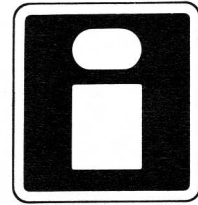

Ingersoll

**ROTARY MOWERS
AHRM48
Operator's Manual 8-57450**

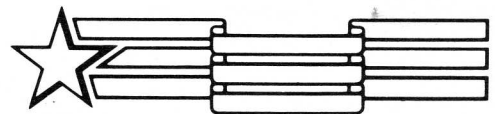

QUALITY IN THE AMERICAN TRADITION

Ingersoll Equipment Co., Inc.

Winneconne, Wisconsin 54986-9576



This Safety Alert Symbol Indicates Important Safety Messages In This Manual When You See This Symbol Carefully Read The Message That Follows and Be Alert To The Possibility Of Personal Injury Or Death

IF THIS MACHINE IS USED BY AN EMPLOYEE OR IS LOANED OR RENTED, MAKE ABSOLUTELY CERTAIN THAT THE OPERATOR(S), PRIOR TO OPERATING:

- 1. IS INSTRUCTED IN SAFE AND PROPER USE.**
- 2. REVIEWS AND UNDERSTANDS THE MANUAL(S) PERTAINING TO THE MACHINE.**

751253

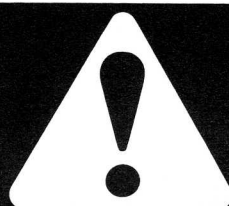

WARNING

BEFORE STARTING ENGINE

**STUDY OPERATOR'S MANUAL SAFETY MESSAGES
READ ALL SAFETY SIGNS ON MACHINE
CLEAR THE AREA OF OTHER PERSONS**

LEARN & PRACTICE SAFE USE OF CONTROLS BEFORE OPERATING

IT IS YOUR RESPONSIBILITY TO UNDERSTAND AND FOLLOW MANUFACTURER'S INSTRUCTIONS ON MACHINE OPERATION, SERVICE, AND TO OBSERVE PERTINENT LAWS AND REGULATIONS. OPERATOR AND SERVICE MANUALS MAY BE OBTAINED FROM YOUR EQUIPMENT DEALER.

SAFETY MESSAGES



The safety messages contained in this manual are to be used together with the safety messages appearing in the tractor operator's manual. Be sure to review both carefully before operating the tractor-mower combination.



Regard your rotary mower as a piece of power equipment and be sure this manual is read and understood by all who operate it.



WARNING: Be sure that the attachment drive clutch is off, the engine is shut off, the key removed and the blades have stopped spinning before attempting to clean a plugged discharge chute.



Maintain your tractor and rotary mower in top operating condition.



CAUTION: Unbalanced blades are a hazard and will cause premature wear and failure of bearings and spindles. If the blades cannot be balanced by resharpener, replace them with new ones.



CAUTION: Clear the lawn or area to be mowed of sticks, stones or any hard objects which could come in contact with the blades and be hurled out the discharge opening.



CAUTION: Never get on or off the tractor while the mower is running.



CAUTION: Do not permit children or pets in the area while mowing and never direct the mower discharge at buildings, people, pets, windows or cars.



CAUTION: Give complete and undivided attention to the job at hand.



WARNING: Keep feet and hands away from discharge opening and make no repairs unless both the tractor engine and attachment drive are shut off and the key is removed from the tractor.



CAUTION: Stop engine, disengage attachment drive, set parking brake and remove the key when tractor is unattended.



CAUTION: Fill gas tank out of doors and avoid spilling gasoline. Do not fill tank with gasoline while smoking or while engine is running. Allow engine to cool several minutes before adding gasoline. Wipe up spilled gasoline.



CAUTION: Do not allow anyone other than the operator to ride on the tractor.



CAUTION: Stop and inspect the mower for damage immediately after striking a foreign object and repair damage before restarting and operating the machine.



CAUTION: Never allow children or young teenagers to operate the tractor and rotary mower.



DANGER: Spinning Blade. Keep clear. Contact can injure.



CAUTION: Disengage attachment drive clutch, stop engine and remove key and spark plug wire(s) before making adjustments.



WARNING: Improper operation of your tractor on hill-sides and slopes can be dangerous. Avoid improper operation! Read and follow the instructions given in the section titled "Hillside Operation" in this manual before operating your tractor.



CAUTION: Shut off engine, allow engine to cool and remove key and spark plug wire(s) before replacing mower drive belt.



CAUTION: Sharp mower blades. Wear gloves or wrap the mower blade with a rag when handling blades. Improper handling can cause cuts to the skin.



CAUTION: Disengage attachment drive clutch when someone approaches or whenever the mower is being transported.



CAUTION: Be sure you know how to stop the tractor and mower at a moment's notice.



WARNING: Flying debris. Operate mower only with discharge chute guard/cover or complete grass catcher in place. Debris may cause injury.



CAUTION: Hydraulic systems are highly pressurized. Escaping hydraulic oil, even an invisible pinhole leak, can penetrate body tissues causing serious injury. Use a piece of wood or cardboard when looking for leaks - never use the hands or other parts of the body.

IMPORTANT: Always install new decals whenever the old decals are destroyed, lost, painted over or illegible. When individual parts are replaced that have decals attached, be sure to install a new decal with the new part. Replacement decals are available from your dealer.

Relieve hydraulic pressure before disconnecting circuits. When reassembling, make absolutely certain that all connections are tight.

If injured by hydraulic oil escaping under pressure, see a doctor immediately. Serious complications may arise if medical attention is not given at once.

HILLSIDE (SLOPE) OPERATION



WARNING: Improper operation of your tractor on hillsides and slopes can be dangerous. Avoid improper operation! Read and follow the instructions given in the section titled "Hillside Operation" in this manual before operating your tractor.

Avoid operating tractor on hillsides and slopes. To minimize the possibility of accidents while operating on hills and/or rough terrain, obey a combination of rules, practices and good common sense.

These include:

1. Reading, understanding, and obeying all written safety messages appearing on decals on the machine and in operator's manuals.
2. Learning from your operator's manual and carefully from EXPERIENCE how to operate your tractor correctly. Know your tractor's limitations.
3. Knowing the terrain on which you are operating your tractor. There are terrain conditions on which your tractor cannot be operated!
4. Learning to expect changes in operating conditions. Adding or removing attachments or weight to your tractor will make your tractor perform differently. Rain, snow, loose gravel, wet grass, etc., change the tractive conditions of the terrain requiring changes in your operating technique or not to operate on that terrain.

The following paragraphs will cover these practices one at a time. Read and study them. The examples provided are not all inclusive but will give you a firm understanding of the requirements for avoiding accidents while operating your tractor.

Ingersoll Lawn and Garden Tractors are designed and built to comply with the Voluntary Standard ANSI (American National Standards Institute).

THE OPERATOR IS THE SOLE JUDGE AS TO THE DEGREE OF SLOPE ON WHICH THIS TRACTOR CAN BE SAFELY OPERATED. IF IN DOUBT THAT THIS TRACTOR CAN BE SAFELY OPERATED ON A PARTICULAR SLOPE, DO NOT OPERATE ON THAT SLOPE! COMMON SENSE MUST PREVAIL.

Read, Understand, Obey:

Safety messages are found on the tractor and in the operator's manuals. These must be understood by the tractor operator to be of value. Be sure that these messages are studied before starting and/or operating the tractor by an operator not familiar with this particular tractor.

Learn to Operate:

Learn your tractor's controls from decals on the tractor and from instructions in the operator's manual. Practice how to properly manipulate these controls. Practice must be done in a flat area, clear of obstacles and bystanders. Learn your tractor's operating characteristics and limitations. These include:

- a. amount of engine power available
- b. engine governor response
- c. tractive ability
- d. steering characteristics
- e. braking characteristics
- f. movement of travel lever
- g. forward and reverse ground speeds
- h. speed of attachment lift
- i. and others

Attempting any operation which approaches or exceeds the tractor's limitation is risking an accident.

Know the Terrain:

Know the terrain on which you are working. Find hidden obstacles by walking through and inspecting the area prior to operating your tractor on it. Mark obstacles, such as, rocks, ruts or holes with a 6 ft. long pole and red flag and stay well clear of these obstacles when operating.

Operate your tractor at a ground speed slow enough to insure complete control at all times.

Place the transmission in low gear and regulate the throttle control lever slowly and smoothly to maintain this safe speed. Do not stop on a hill or slope to change gears.

Always drive in a forward direction when proceeding downhill. Never drive up a hill. If necessary, back up a hill to the desired position. Always back up loading ramps and tilt bed trailers. If necessary to turn while on a hill, always turn downward.

Your judgement, based on operating experience is the final word in deciding if you should negotiate any given hill or slope. If you are in doubt about safety, **STAY OFF THE SLOPE.**

Under no circumstances should an inexperienced operator attempt to use your tractor on slopes or hill-sides.

You may encounter some terrain on which your tractor cannot be operated even if a different piece of equipment has operated there in the past.

Learn to Compensate for Changes in Operating Conditions:

Adding or removing attachments or ballast (such as wheel weights or fluid) change the weight and weight distribution of your tractor and, therefore, changes your tractor's operating characteristics.

Be alert to these changes. Practice operating the tractor after each change has been made.

Adding an attachment (weight) to the rear of the tractor reduces the weight on the front axle. Adding an attachment (weight) to the front of the tractor reduces weight on the rear of the tractor. You must add counterweight to the front if a rear mounted attachment is installed. You must add counterweight to the rear if a front mounted attachment is installed.

Tractive conditions will vary with weather and terrain and equipment.

Areas wet with dew or rain will be more slippery than when dry. Areas covered with loose gravel are more slippery than firm dry ground. Greater stopping distances are required in these slippery areas.

Spinning rear wheels tend to move the tractor sideways. The addition of tire chains will provide more traction to the rear wheels in the forward-reverse direction but less stability in the sideways direction. Chains will cause more abrupt starting and stopping.

The final word in safe tractor operation rests on your judgement.

If in doubt of your safety, **STAY OFF THE SLOPE.**

INTRODUCTION

This operator's manual includes:

- a. Safety Rules
- b. Installation Procedure
- c. Operating Procedure
- d. Adjustments
- e. Maintenance

Read this manual before operating your rotary mower.

See your authorized dealer for parts or repairs.

The words "Right, Left, Front and Rear as used in this manual indicate directions when you are in the operator's seat in the normal operating position.

NOTE: We reserve the right to make improvements in design or changes in specifications at any time without incurring any obligation to install them on units previously sold.

ATTACHMENT APPLICATION CHART

MODEL	SIZE	TRACTOR MODEL
AHRM48	48" (1220 mm)	3118, 4116, 4118, 4120

OPERATING CONTROLS

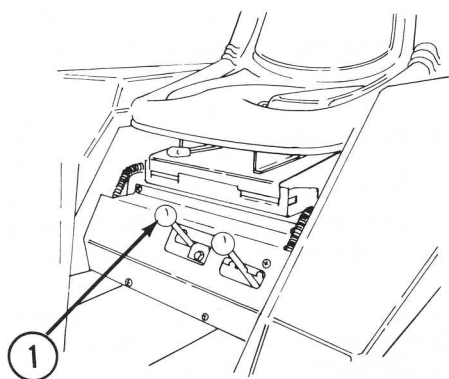

FIGURE 1

1. ATTACHMENT DRIVE PTO

The rotary mower is started and stopped with attachment drive PTO lever. The PTO lever is located to front and below operator's seat.

To **START** mower move PTO lever to the right.

To **STOP** mower move PTO lever to the left into the neutral position.

NOTE: A lock-out bracket is installed on PTO lever to prevent reverse operation. Damage may result from reverse operation. Keep bracket in place for all mowing procedures.

2. HYDRAULIC ATTACHMENT LIFT LEVER

The rotary mower is raised and lowered with the attachment lift lever.

When mowing, put the attachment lift lever in the "LOWER" position until the lift arms (4) are midway in the lift link (5) slots.

See your tractor operator's manual for correct use of your tractor controls.

3. HEIGHT SELECTOR LEVER

The cutting height is controlled by the height selector lever.

TO INCREASE THE CUTTING HEIGHT:
Disengage the pin and pull the height selector lever up.

TO DECREASE THE CUTTING HEIGHT:
Disengage the pin and push the height selector lever down.

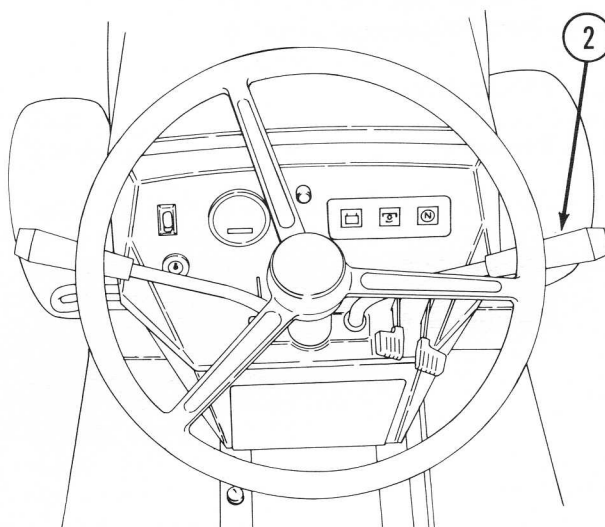
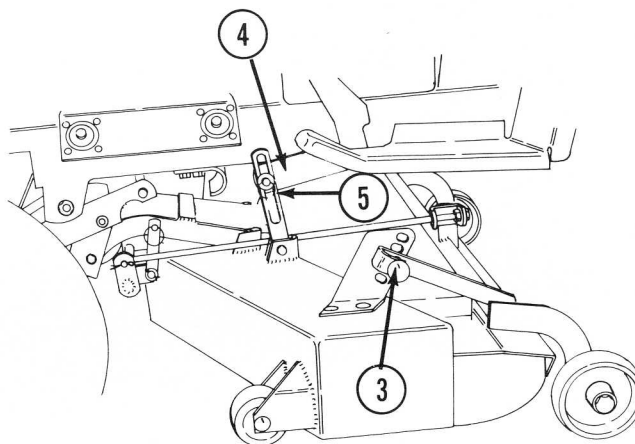

FIGURE 2



- 3. Height selector lever
- 4. Lift arm
- 5. Lift link

FIGURE 3

OPERATION

1. See the "ADJUSTMENTS" and "MAINTENANCE" sections of this manual before operating your rotary mower.
2. See your tractor operator's manual for correct use of your tractor controls.
3. Learn to operate the tractor and rotary mower in an area clear of persons and obstructions.
4. Check the work area for obstructions. Remove the small obstructions. Mark the large obstructions so you can see them. Do not hit the large obstructions.
5. Get on and get off the tractor correctly. Never use the lawn mower frame for a step.



WARNING: Be sure that the attachment drive clutch is off, the engine is shut off, the key removed and the blades have stopped spinning before attempting to clean a plugged discharge chute.

TO GET ON THE TRACTOR FROM THE RIGHT SIDE:

- a. put your right foot on the right foot rest
- b. put your right hand on the steering wheel
- c. put your left hand on the seat back
- d. swing your left leg between the steering wheel and seat



CAUTION: Never get on or off the tractor while the mower is running.



CAUTION: Never allow children or young teenagers to operate the tractor and rotary mower.



CAUTION: Clear the lawn or area to be mowed of sticks, stones or any hard objects which could come in contact with the blades and be hurled out the discharge opening.

TO GET ON THE TRACTOR FROM THE LEFT SIDE:

- a. put your left foot on the left foot rest
- b. put your left hand on the steering wheel
- c. put your right hand on the seat back
- d. swing your right leg between the steering wheel and seat

Use reverse procedure to get off the tractor.



Regard your rotary mower as a piece of power equipment and be sure this manual is read and understood by all who operate it.

6. Put tractor transaxle range lever in the low position.
7. Start the rotary mower by setting the engine throttle at 1/3 speed and move the attachment PTO lever (1) to the right.



DANGER: Spinning Blade. Keep clear. Contact can injure.

8. Lower the lawnmower to the cutting position. Make sure the lift arms (4) are located in the center of the slots in the lift links (5). This permits free movement of the lawnmower.

Do not put the attachment lift lever (2) in the "FLOAT" position.



WARNING: Improper operation of your tractor on hillsides and slopes can be dangerous. Avoid improper operation! Read and follow the instructions given in the section titled "Hillside Operation" in this manual before operating your tractor.



CAUTION: Stop and inspect the mower for damage immediately after striking a foreign object and repair damage before restarting and operating the machine.

MOWING CONDITIONS

Mowing conditions can be different. You must use the correct operating methods according to the following chart:

CONDITION

METHOD

- | | |
|----------------------------------|--|
| 1. Short or thin grass. | 1. a. move the height selector lever (3) to the cutting height needed.

b. move the throttle lever to a position between 3/4 and full throttle.

c. adjust ground speed as needed. |
| 2. Long or thick grass. | 2. a. move the height selector lever (3) to the highest position.

b. increase engine speed to the "FULL THROTTLE" position.

c. reduce ground speed.

d. cut long or thick grass twice.

e. operate with the chute facing the cut area. |
| 3. Wet grass. | 3. a. do not cut wet grass. |
| 4. Rough terrain. | 4. a. raise the mower into the transport position.

b. put the gauge wheels (7) in the "M" position.

c. operate the mower in the transport position to keep the gauge wheels (7) off the ground.

d. reduce ground speed. |
| 5. Cutting near objects. | 5. a. use the left side of the rotary mower.

The cut material will be moved away from the object. |
| 6. When grass will not be swept. | 6. a. operate with chute facing the cut area. |
| 7. When grass will be swept. | 7. a. operate with chute facing the uncut area.

b. the grass will be in one strip and can be removed with a sweeper. |
| 8. Wind. | 8. a. turn the tractor so the wind will move grass away from you. |

ADJUSTMENTS

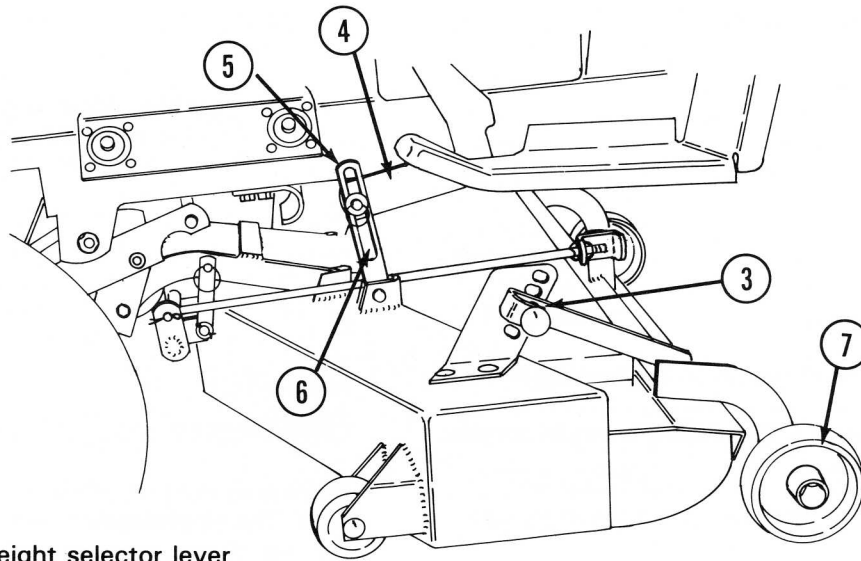

- 3. Height selector lever
- 4. Lift arm
- 5. Lift link
- 6. Lift link slot
- 7. Gauge wheel

FIGURE 4



WARNING: Keep feet and hands away from discharge opening and make no repairs unless both the tractor engine and attachment drive are shut off and the key is removed from the tractor.

HEIGHT SELECTOR LEVER (3)

You can adjust the lawnmower height with the height selector lever (3).

TO CHANGE THE CUTTING HEIGHT:

1. Raise the lawnmower into the transport position. This will decrease the weight on the height selector lever (3).
2. Pull outward on the pin.
3. Move the lever up or down to the needed height.
4. Push the pin into the hole selected.

GAUGE WHEELS (7)

SMOOTH TERRAIN

1. Always operate the rotary mower with the gauge wheels (7) on the ground. Make sure all weight is off the lift links (5) for the rotary mower. The lift links (5) must move freely to cut level and even.
2. The gauge wheels (7) must not contact the ground while the lawnmower is in the transport position.

ROUGH TERRAIN

1. Operate the rotary mower in the transport position and with the height selector lever (3) in the "M" position. This will keep the gauge wheels (7) from contacting the ground.
2. Reduce ground speed.

LAWNMOWER FRONT TO REAR LEVEL

Smooth cutting and minimum horsepower consumption are a result of a level rotary mower.

BEFORE STARTING THE PROCEDURE:

1. Put the tractor and rotary mower on a level surface, like a concrete floor.
2. Put the height selector lever (3) in the "M" position.
3. Lower the lawnmower to the cutting position.

TO RAISE THE FRONT OF THE LAWMOWER:

1. Loosen the front nut (9) on the leveling rod (8).
2. Turn the rear nut (9) forward an equal number of turns.

TO LOWER THE FRONT OF THE LAWMOWER:

1. Loosen the rear nut (9) on the leveling rod (8).
2. Turn the front nut (9) rearward an equal number of turns.

TO CHECK FOR LEVEL:

1. Rotate the blades until they are parallel to the tractor frame from front to rear.
2. Make sure the nuts (9) on the leveling rod (8) are tight.
3. Measure the distance from the blade ends to the level surface. Make sure you measure as near the blade end as possible.

The lawnmower is level when both front and rear blade measurements are the same. The front end may be 1/8" (3 mm) lower than the rear end. Never permit the rear end to be lower than the front end. This will cause more than normal power consumption.

LAWNMOWER SIDE TO SIDE LEVEL

Make sure the problem is not the air pressure in the tires. The air pressure in both tires must be correct and equal.

Lawnmower side to side level is not adjustable.

**ADJUST NUTS (9) FORWARD TO
RAISE FRONT OF MOWER**

**ADJUST NUTS (9) REARWARD TO
LOWER FRONT OF MOWER**

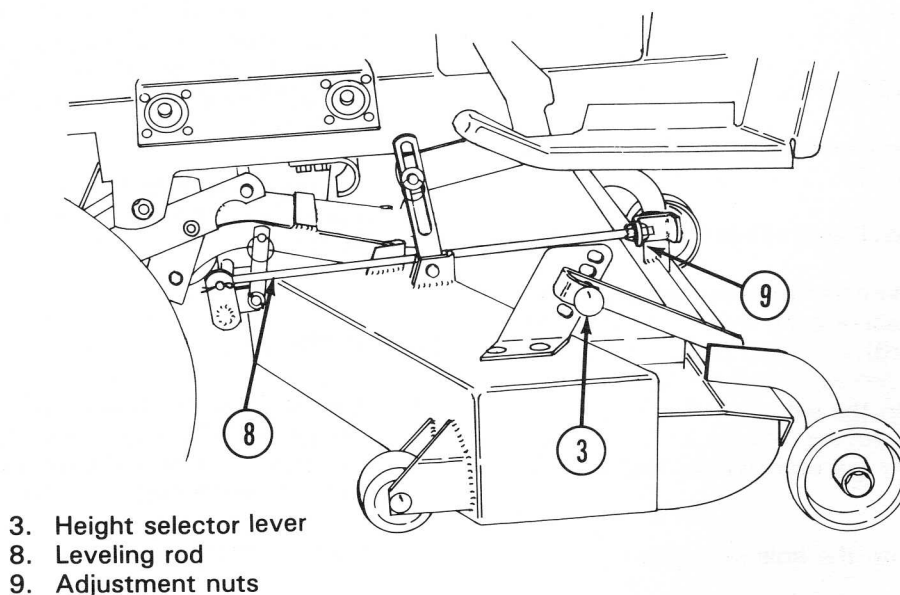

FIGURE 5

MAINTENANCE



CAUTION: Disengage attachment drive clutch, stop engine and remove key and spark plug wire(s) before making adjustments.

BLADE BOLTS (10)

Before you operate the lawnmower for the first time, check the bolts (10) holding the blades. The bolts (10) must be tight. After the first eight hours of operation, check the bolts (10) again. Each time the blades are removed, install new lock washers under the bolt (10) heads. Tighten the bolts (10) and check again after 8 hours of operation.

BENT BLADES

Check for a bent blade before you install the lawnmower on the tractor. Check the blades for damage after you hit foreign material.

The ends of the blades must be aligned horizontally. A 1/8" (3 mm) difference is acceptable.

Align two blades as shown in Figure 6. Check all six ends in a similar way. Replace all bent blades.

Bent blades will not cut grass even.



CAUTION: Sharp mower blades. Wear gloves or wrap the mower blade with a rag when handling blades. Improper handling can cause cuts to the skin.

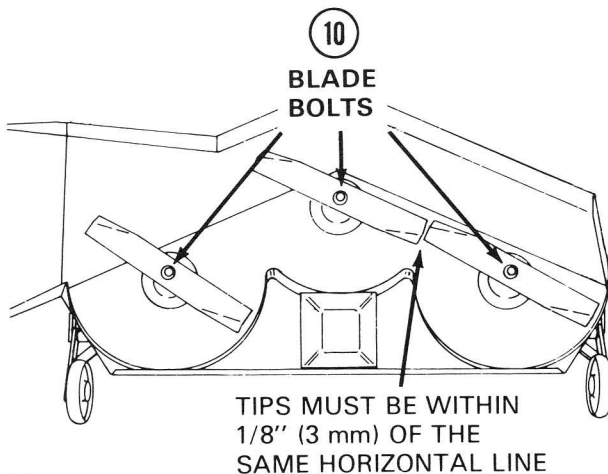

FIGURE 6

SHARP BLADES

Stop the engine. Wait for all motion to stop. Be careful while you check the lawnmower blades. After each job check for damage or blade wear.

A blade that is worn can give a rough cut and brown areas of grass can result.

See Figure 7 for the correct angle of the cutting edge. The cutting edge must be at least 3-1/2" (90 mm) long.

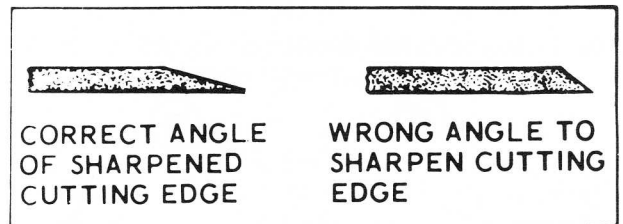

FIGURE 7

After grinding a blade, check for balance. Use a balance tool as shown. A balanced blade will stay in a horizontal position.

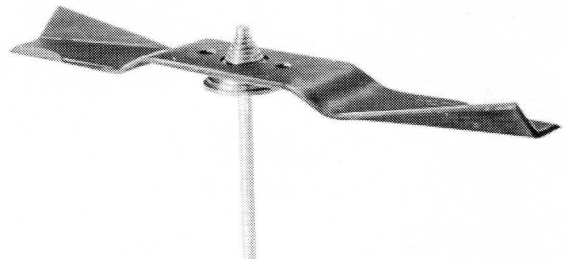

FIGURE 8



CAUTION: Sharp mower blades. Wear gloves or wrap the mower blade with a rag when handling blades. Improper handling can cause cuts to the skin.



CAUTION: Unbalanced blades are a hazard and will cause premature wear and failure of bearings and spindles. If the blades cannot be balanced by resharpener, replace them with new ones.

DECK BELT REPLACEMENT

See Figure 9.

1. Remove deck belt guard.
2. Release idler pulley (25) tension.
3. Remove old belt (27).
4. Put new belt (27) around pulleys as shown in figure 9. Make sure backside of belt rides in flat groove of idler pulleys (24 and 25).
5. Manually rotate the belt (27). Check for free movement of belt (27). Make sure idler pulley (25) has tension.
6. Install deck belt guard.

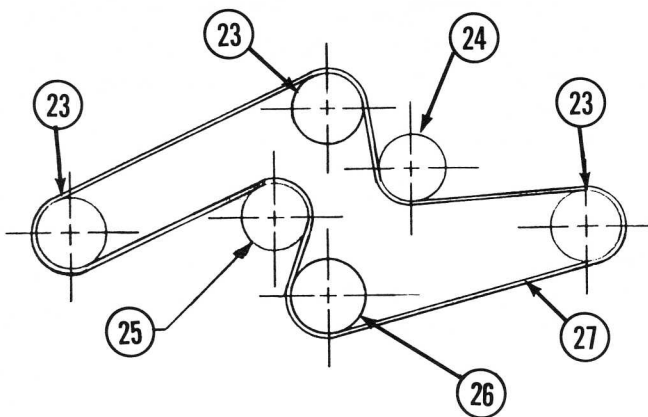

- 23. Spindle pulley
- 24. Fixed idler pulley
- 25. Tensioned idler pulley
- 26. Drive pulley
- 27. Belt

FIGURE 9 Deck Belt

CLEANING UNDER THE LAWNMOWER

Large amounts of grass sticking under the mower deck will:

1. cause more than normal horsepower consumption
2. cause an obstruction
3. cause a bad cutting job
4. cause corrosion
5. damage bearings or seals

Stop the engine. Wait for all motion to stop. Use caution when you check the lawnmower deck. Periodically check and clean the deck. Remove the grass wound between the blade mounting plates and spindle housings.



DANGER: Spinning Blade. Keep clear. Contact can injure.

SPINDLE LUBRICATION

This mower is equipped with greaseable spindles. The fittings are located on the spindle housings under the deck.

Apply grease to each fitting every 8 hours of use.

Clean the area around the fitting to keep dirt out.

Use a good grade of gun grease (lithium base) as required.

ASSEMBLY

1. Remove components from the box.

NOTE: The lift links for your mower are included with your tractor.

2. Put mower upside down.
3. Install protective plastic moulding (12) to holes in rear of deck. These holes are for hose routing.
4. Connect the longer 1/2" I.D. hose to inlet (14) of mower hydraulic motor. Use 90 degree tube end of hose and install through hose routing hole. This is L.H. fitting with mower in normal cutting position.

Install 90 degree fitting and male coupling to other end of this hose.

5. Install the shorter 1/2" I.D. hose to outlet (15) of mower hydraulic motor. Use 90 degree tube end of hose and install through hose routing hole. This is R.H. fitting with mower in normal cutting position.

Install 90 degree fitting and female coupling to other end of this hose.

6. Install 1/4" I.D. hose to case drain (13) port on mower hydraulic motor.

Route through same hole as outlet (15) hose. Install smaller 90 degree fitting and female coupling to other end of this hose.

7. Install skid plate to mounting tabs (16). Use bolts and nuts provided.
8. Turn mower over.
9. Use clevis pins and retaining rings to secure the lift links to the outer anchor points.
10. Install the discharge chute (11) using the pin, spring and push nuts provided.

NOTE: The spring must be positioned so it holds the chute downward.



WARNING: Flying debris. Operate mower only with discharge chute guard/cover or complete grass catcher in place. Debris may cause injury.

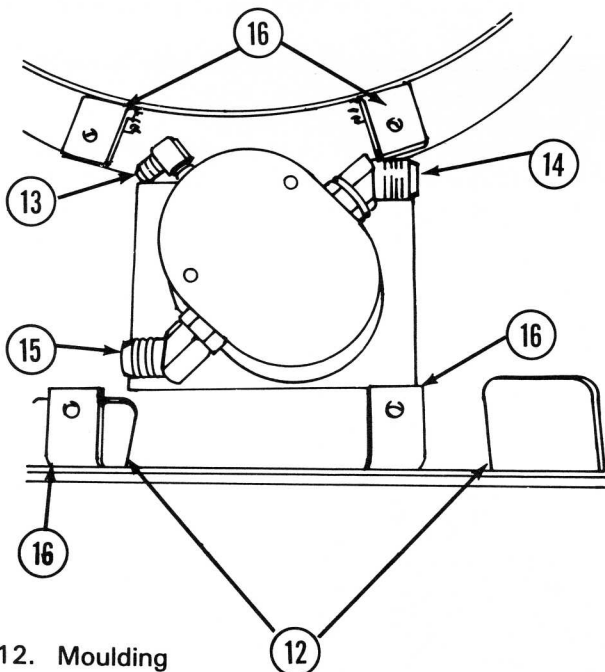

12. Moulding
13. Case drain
14. Inlet
15. Outlet
16. Mounting tabs

FIGURE 10

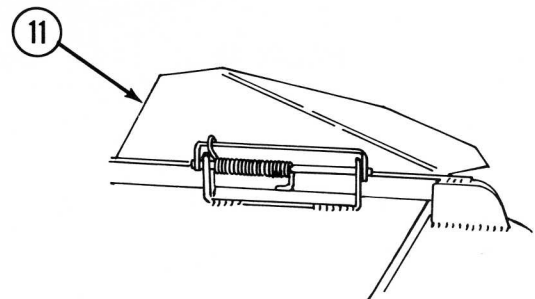

11. Discharge chute

FIGURE 11

NOTE: Do not preassemble the mounting bracket to the mower deck.

INSTALLATION

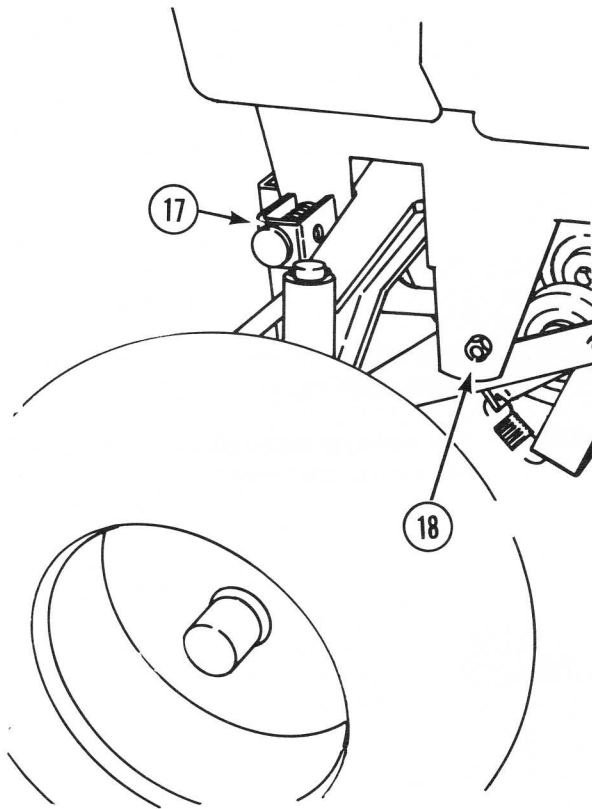

- 17. Snap fast pin
- 18. Anchor pin

FIGURE 12

1. Put the tractor on a clean level surface to permit easier installation.
2. Put the height selector in the "M" position.
3. Slide the deck under the tractor from the left hand side.
4. Pull out and lock the snap fast pins (17) in the open position.
5. Install the mounting bracket from the front:
 - a. guide the slots in the mounting bracket over the anchor pins (18) in the tractor frame.
 - b. guide the snap fast pin (17) holes in the mounting bracket into the snap fast receptacles in the tractor frame.
 - c. Release the snap fast pins (17) to secure the mounting bracket.
 - d. guide the mounting arms (20) into the in-board anchor points on the deck. Fasten the mounting arms (20) using the clevis pins and retaining rings provided.
 - e. Lift the front of the deck, if necessary, and secure the links (21) from the leveler cross shaft (19) to the mounting arms (20). Use the clevis pin and retaining ring provided.
6. Lower the attachment lift to the fully lowered position.
7. Place the lift links (5) on the outside of the lift arms (22) and secure with the clevis pins (installed from the inside out), flat washer, and retaining ring provided.

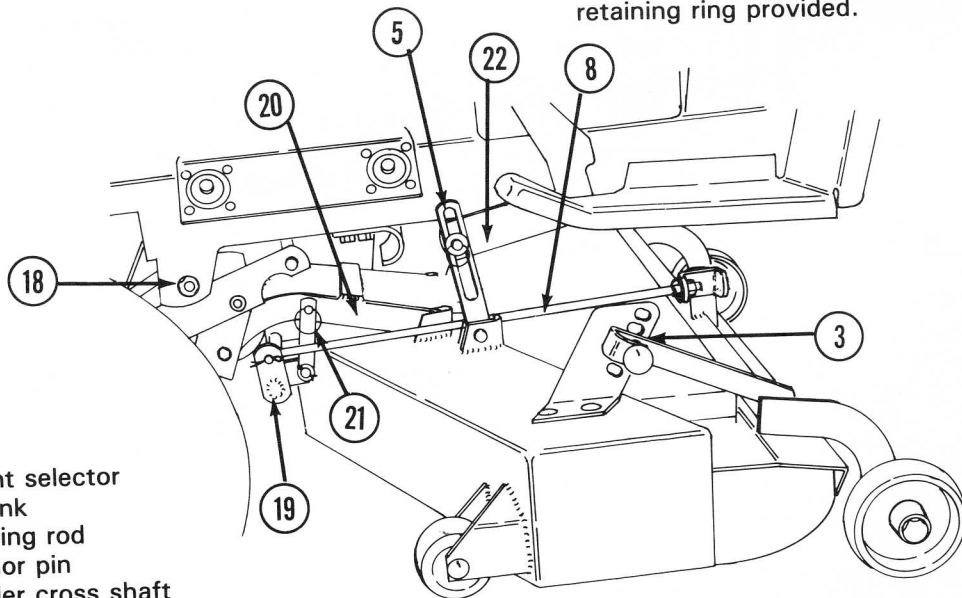

- 3. Height selector
- 5. Lift link
- 8. Leveling rod
- 18. Anchor pin
- 19. Leveler cross shaft
- 20. Mounting arms
- 21. Leveler link
- 22. Lift arms

FIGURE 13

8. Connect quick couplers from mower to couplers at rear of tractor. All three hydraulic lines must be connected before you operate the mower or damage can result.



CAUTION: Hydraulic systems are highly pressurized. Escaping hydraulic oil, even an invisible pinhole leak, can penetrate body tissues causing serious injury. Use a piece of wood or cardboard when looking for leaks - never use the hands or other parts of the body.

Correct routing for hydraulic lines will be from:

Right fitting of mower hydraulic motor to right coupler (1) at rear of tractor.

Left fitting of mower hydraulic motor to left of coupler (2) at rear of tractor.

Case drain (1/4" I.D. hose) on hydraulic motor across to coupler (3) at left rear of tractor.

9. Before operating mower, make sure hydraulic fittings are tight.

Relieve hydraulic pressure before disconnecting circuits. When reassembling, make absolutely certain that all connections are tight.

If injured by hydraulic oil escaping under pressure, see a doctor immediately. Serious complications may arise if medical attention is not given at once.

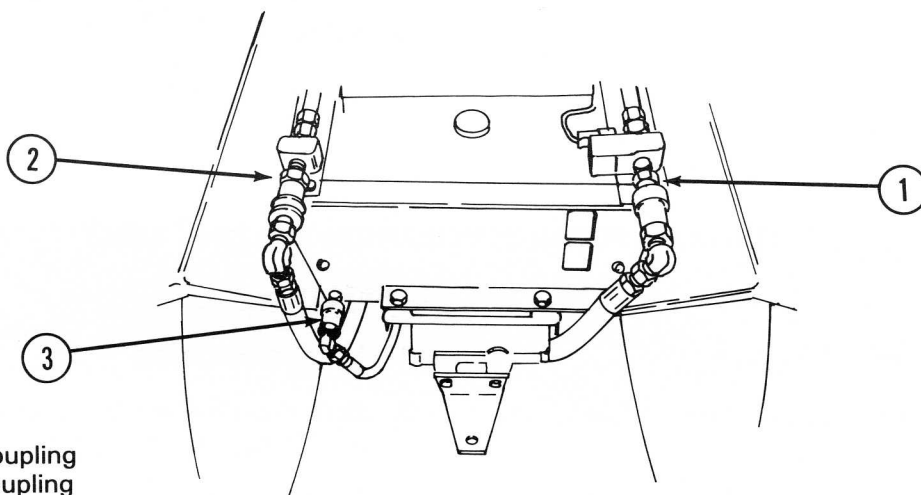

1. R.H. Coupling
2. L.H. Coupling
3. Case drain

FIGURE 14

REMOVAL

NOTE: Be sure engine and hydraulic PTO are off before mower removal.

1. Disconnect couplers. Connect mower couplers together or install protective caps to keep dirt out.
2. Install protective caps on tractor couplers.

3. Disconnect mounting bracket from mower deck. Pull out snap fast pins. Remove mounting bracket from tractor.
4. Remove mower deck.
5. Store in a dry place.

TROUBLESHOOTING CHART

LAWNMOWER NOT CUTTING EVEN OR LEAVING A STRIP OF GRASS

POSSIBLE CAUSE

CORRECTION

1. Obstruction in bottom of mower deck.
2. Blades not sharp.
3. Engine speed too slow.
4. Travel speed too fast.
5. Grass too long.
6. Deck belt slippage.

1. Remove deck and clean.
2. Cutting edge must be sharp and at least 3-1/2" (89 mm) long.
3. Adjust engine speed to 3600 RPM.
4. Decrease travel speed.
5. Cut twice. First at highest position then at needed height.
6. Check belt. Adjust tension or replace.

LAWNMOWER CUTS HIGH ON ONE SIDE

POSSIBLE CAUSE

CORRECTION

1. Lawnmower deck not level side to side.

1. Check for equal tire pressure or worn gauge wheels.

TOO MUCH POWER CONSUMPTION AND CUTS BADLY

POSSIBLE CAUSE

CORRECTION

1. Blades not sharp.
2. Lawnmower deck not level front to rear.
3. Blades installed upside down or wrong blades installed.
4. Blade not straight.

1. Make blades sharp.
2. Deck must be level or no lower than 1/8" (3 mm) in front (first check air pressure in tires).
3. Install correctly. Blades rotate clockwise. Cutting edge must lead.
4. Replace blade.

CENTER BLADE ONLY CUTTING

POSSIBLE CAUSE

CORRECTION

1. Deck belt broken or idler spring disconnected.

1. Replace belt or spring as required.

Printed in U.S.A.