



**Operators Manual  
Model J 30  
Hydraulic Lift Kit**

Win. Form No. 9-99682



## INTRODUCTION

The Model J-30 Hydraulic Lift Kit is designed for use on Case Model 220 S/N 9656747 and after, 222 S/N 9658189 and after, 224 S/N 9667000 and after. This kit is intended for dealer installation only.

This manual covers recommended operating procedures, safety suggestions, adjustments, maintenance information and installation instructions. Additional information is contained in your Tractor Operator's Manual. Read these manuals carefully before operating the Hydraulic Lift Kit.

The definitions "Right, Left, Front and Rear" as used throughout this manual relate to the tractor and Hydraulic Lift as the operator is seated facing forward in the normal operating position on the tractor.

Always make certain the Tractor Attachment Drive Clutch is disengaged before starting the engine and when transporting any power driven attachment.

## OPERATION AND ADJUSTMENT

1. The components of the Hydraulic Lift Kit are identified in Figure 2 with the same description used throughout this manual.
2. Oil all of the pivot points on the lift cylinder and lift lever shaft daily when the tractor is in use.
3. Lubricate the fitting at the center of the lift lever assembly, Figure 2, every 10 hours of operation.
4. Pull back on the Lift Lever, Figure 1, to raise the attachment. To lower the attachment and apply "down pressure" push the lever ahead to the first stop position. The control valve has a centering spring which returns the lever to neutral from either the "raise" or the "lower" and "down pressure" positions.
5. NEVER apply "down-pressure" to the mower.
6. When the Hydraulic Lift Kit is first installed on the tractor, the hydraulic reservoir oil level must be checked following the first few minutes operation. Operate the Lift Control Lever in both directions to fill the hoses, lines and cylinder with oil. Maintain the hydraulic reservoir oil level as indicated in the tractor operators manual. Normally about one additional quart of oil will be required when the Hydraulic Lift Kit is initially installed. Refer to the tractor Operator's Instruction Manual for the recommended oil specifications. Check the oil level periodically.
7. Check each of the hydraulic connections after the first few minutes operation for oil leakage. Check again after five to ten hours of operation to make certain they are all seated. Once the connections are properly seated, further adjustments are unnecessary.
8. A protective coating of oil will remain on the piston rod each time the cylinder is extended. This can eventually accumulate at the base of the cylinder tube. Wipe any excess of oil off the cylinder tube as necessary.

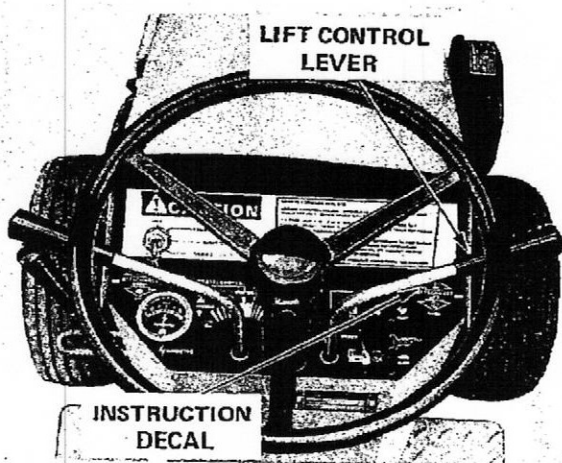

FIGURE 1. OPERATING CONTROLS

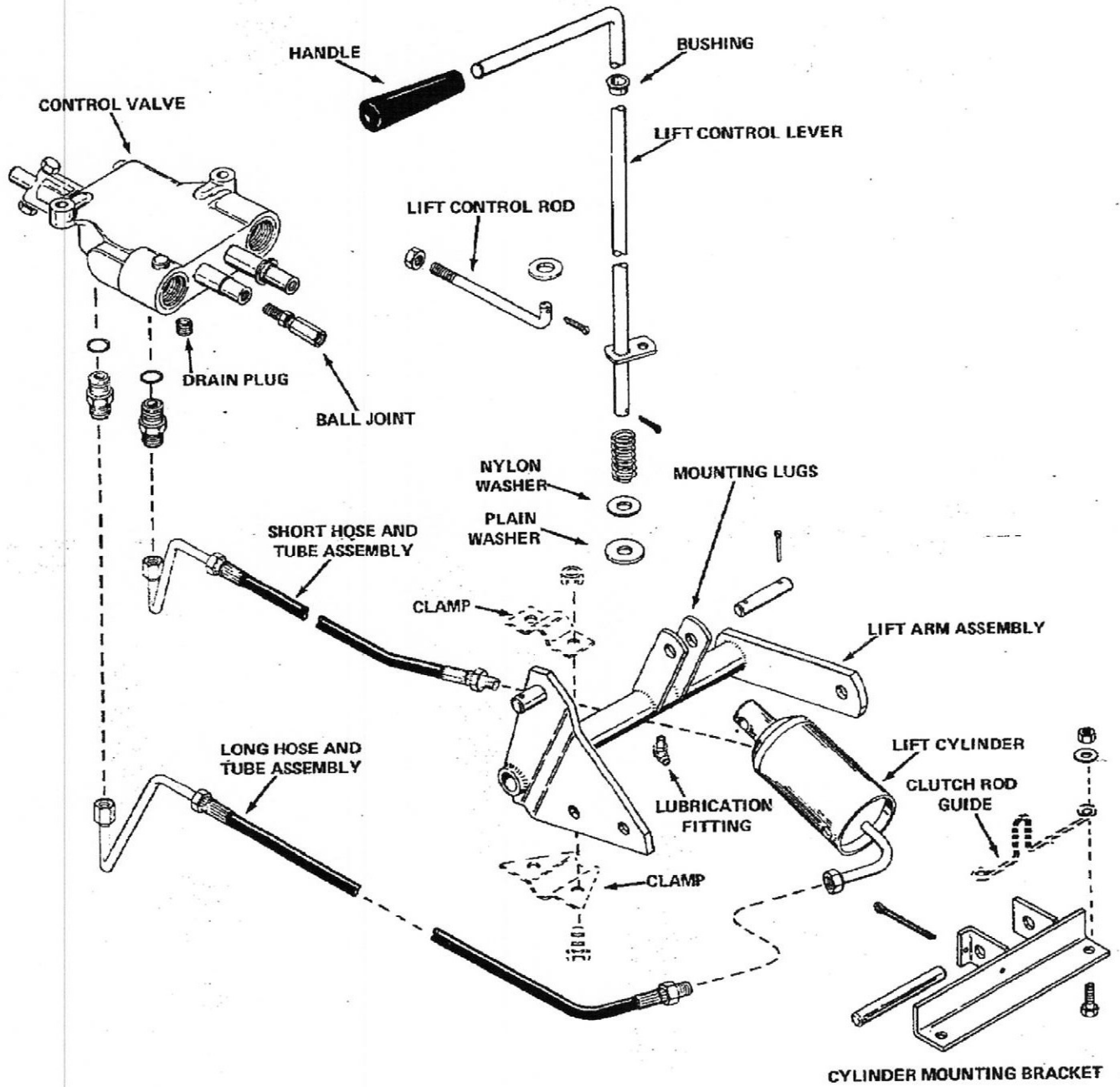

FIGURE 2. HYDRAULIC LIFT KIT ASSEMBLY

**INSTALLATION**

- A. Locate the tractor on a clean surface.
- B. Before installing the Hydraulic Lift Kit, lay out the components on a clean surface similar to arrangement shown in Figure 2. To simplify the original installation, all components are preassembled as far as practical.
- C. Before disconnecting any oil lines on the tractor, place a clean container under the connection to prevent the oil in the lines from draining on the floor.

1. Drain the hydraulic reservoir into a clean container of at least 6 quarts capacity. The drain plug is located at the bottom side of the tractor control valve. See Figure 2. Also drain fuel tank.

**NOTE:** Perform steps 2, 3 and 4 while the reservoir is draining.

2. Install the Lift Control Lever as follows:

- a. Remove the steering wheel.
- b. Remove the plug from the console where the lift lever is to be inserted.
- c. Remove the battery and the battery tray. If the battery is activated, leave it out until the lift kit is installed so the front end of the tractor can be raised.
- d. For maximum clearance, detach the control rod from the lever. Insert the handle end of the control lever through the hole in the console with the lower end of the lever located across the pump and brake pedal.
- e. Work the control lever up through the console until the lower end is clear of the pump; then reconnect the control rod so the threaded end points downward.
- f. Remove the cotter pin and plain washer from the lower end of the control lever shaft and place the shaft through the mounting hole in the steering support casting with the nylon washer and spring located above the support. Place the plain washer over the end of the shaft and install the cotter pin. This is done by depressing the control lever.
- g. Apply silicone seal under the rolled end of the bushing. Push the bushing over the lever and into the console.
- h. Coat the end of the lever with Loctite and install the plastic handle.

- i. Replace the steering wheel and adjust for end play.

3. Remove the mechanical lift lever as follows:

**NOTE:** The components removed or installed at the underside of the tractor will be more accessible if the front end of the tractor is raised and blocked in a near vertical position. Make certain the battery is removed and fuel tank sufficiently drained.

- a. Disconnect front end of drag link.
- b. Remove the foot pads.
- c. Disconnect the brake rod from the brake pedal.
- d. Remove the clamps holding the mechanical lift arm assembly to the tractor frame, remove the cotter pin from the brake pivot shaft and remove the assembly.
- e. Remove the lift arm transport latch from the tractor.

4. Install the hydraulic lift arm assembly as follows:

- a. Slide the assembly onto the cross shaft and install the original clamps shown in Figure 2. Center the brake pivot shaft and install the cotter pin through the right side next to the tractor frame.
- b. Install the drag link, foot pads and brake rod.

5. Disconnect the tubes and travel control rod from the control valve and remove the valve assembly from the tractor.

**NOTE:** Be very careful when removing or installing hydraulic lines to prevent foreign material such as dirt or paint chips from entering and damaging the hydraulic system components.

- 6. Transfer the four fittings and ball joint from the original control valve to the new valve.
- 7. Bolt the new valve loosely to the tractor and reconnect the four tubes. When the tubes are installed and tightened, secure the valve mounting bolts.

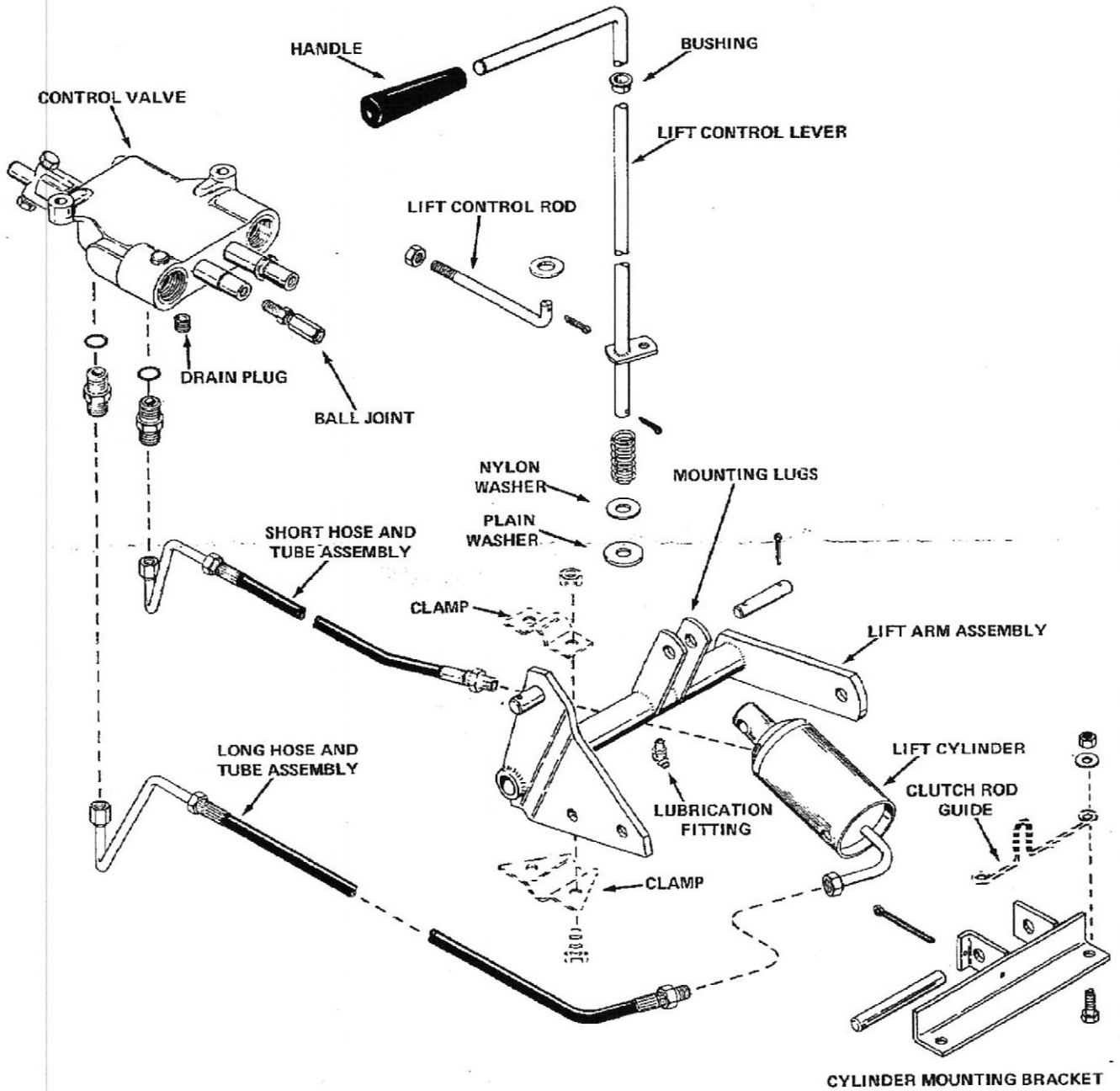

FIGURE 2. HYDRAULIC LIFT KIT ASSEMBLY

8. Connect the lift and travel control rods to the valve spool ball joints. Adjust the travel control rod so that when the travel lever is in the neutral notch, the dimension from the valve body to each snap ring on the valve spool is identical. Adjust the lift control rod so that when in neutral the handle points at the same angle to the right as the travel control handle points to the left. The lift control rod must be adjusted long enough not to go into an over center position when the control handle is in full float detent.
9. Install the shorter hose and tube assembly to the port at the rod end of the lift cylinder. Connect the longer hose to the elbow at the base of the cylinder. Apply a good pipe thread sealer or teflon tape on the hose threads before installing. With the cylinder positioned as shown in Figure 2, the tube ends must point straight upward.
10. Remove the plugs from the tube ends and pull the cylinder rod to the fully extended position to provide clearance for the mounting pin. Re-install plugs for dirt protection.
11. Remove the wire clutch rod guide and two spacers located just ahead of the engine at the underside of the frame.
12. Place the cylinder and mounting bracket assembly into the frame channels and slide far enough forward to place the hose and tube assemblies through between the steering support upper right side frame rail.
13. Tie up the lift arm assembly in the raised position with a piece of soft wire or twine. Align the cylinder rod with the holes in the mounting lugs and install the mounting pin. Insert the cotter pins through the mounting pin.
14. Tighten the hose and tube assemblies onto the control valve fittings.
15. Align the cylinder mounting bracket with the holes in the frame. Place the clutch rod guide over the bracket and insert two bolts. Secure with original plain washers and locknuts. Do not use the original spacers which were provided.
16. Lubricate the lift arm assembly at fitting provided.
17. Lower the front end of the tractor to the floor and untie the lift arm assembly.
18. Fill the hydraulic reservoir with clean recommended oil.
19. Install the battery tray and battery and add fuel.
20. Start the tractor and operate the cylinder to open and closed positions several times. Also operate the tractor in forward and reverse. Check and add oil as necessary to bring to recommended level. Check to make certain all connections are tight and there are no oil leaks.

**NOTE:** THE J I CASE COMPANY reserves the right to make improvements in design or changes in specifications at any time without incurring any obligations to install them on units previously sold.

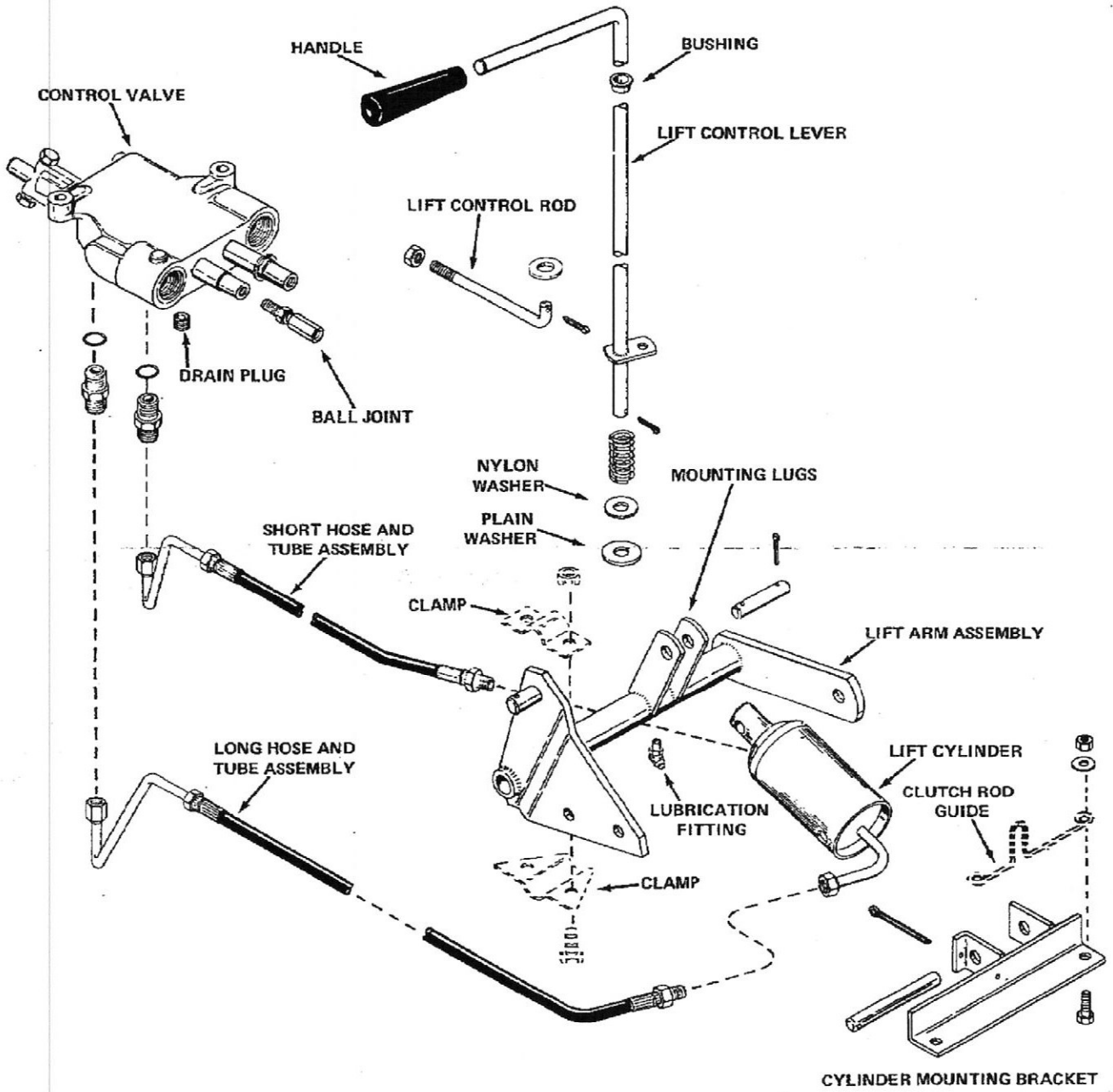

FIGURE 2. HYDRAULIC LIFT KIT ASSEMBLY

Jun 08 13 12:47p

RECEIVED 01/01/2008 02:18 2184205  
Barneveld Implement

M KITCHEN  
16089241662

p.9

Printed in USA

Price \$.45

ANTAO