

ELECTRIC STARTER KIT TYPE 22736-01

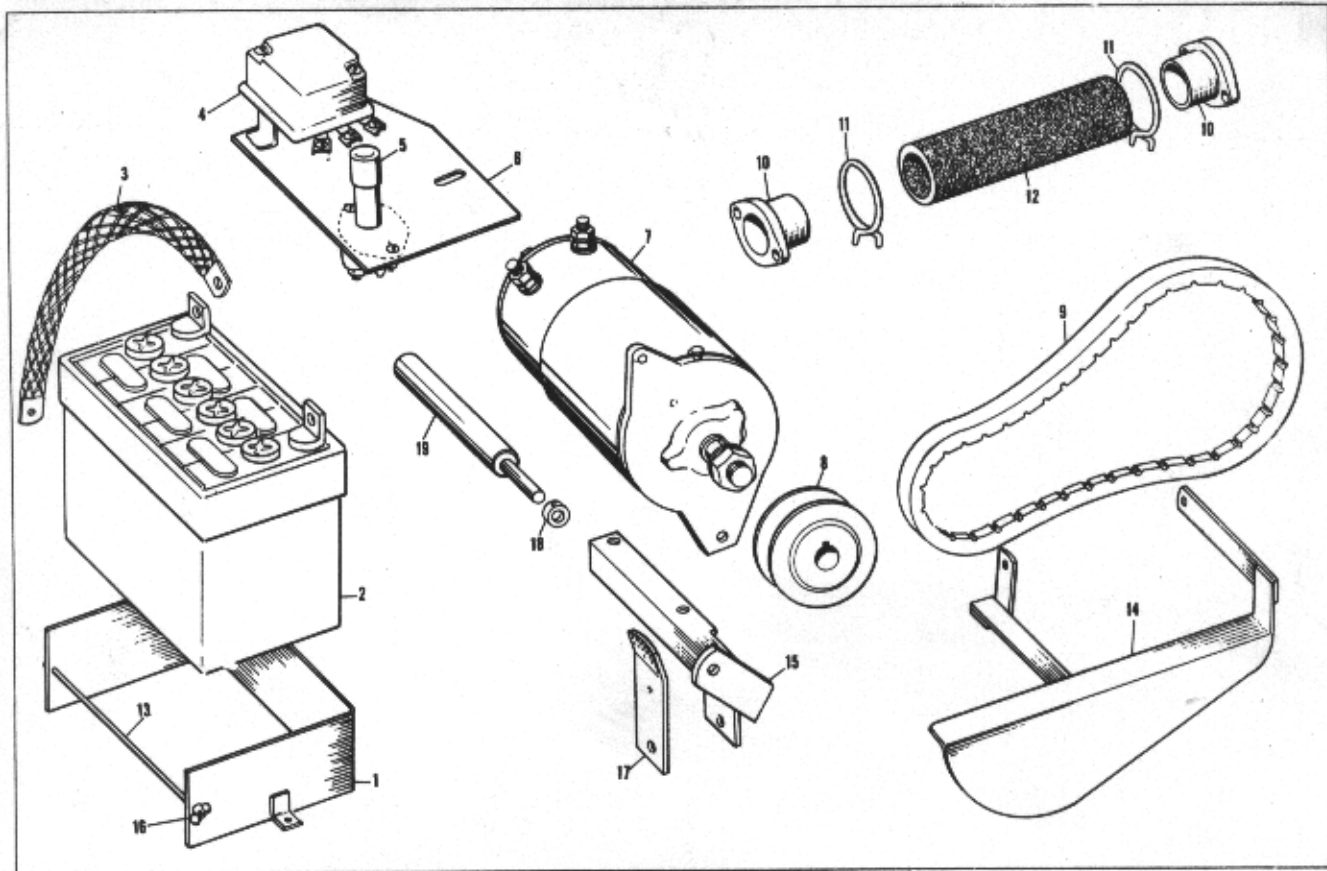

Ref No.	Part No.	Description	No. Reqd.
1	170-8281	Battery Case	1
2	170-8284	Battery	1
3	170-8290	Ground Wire	1
4	170-8287	Voltage Regulator	1
5	170-8285	Starter Switch	1
6	170-8289	Starter Plate	1
7	170-8288	Starter-Generator	1
8	170-8293	Pulley	1
9	170-8425	"V" Belt, 28"	1
10	170-8286	Hose Adapter	2

Ref No.	Part No.	Description	No. Reqd.
11	170-8424	Hose Clamp	2
12	170-8292	Carburetor Hose	1
13	170-8282	Bolt	1
14	170-8488	Belt Guard Assembly	1
15	170-8276	Support Bracket	1
16	110-0241	Wing Nut	1
17	170-8277	Belt Tightener Plate	1
18	170-8006	Set Collar (supplied with tractor)	1
19	170-8005	Support Shaft (supplied with tractor)	1
20	170-8913	Battery Cover (not illustrated)	1

WIRING DIAGRAM

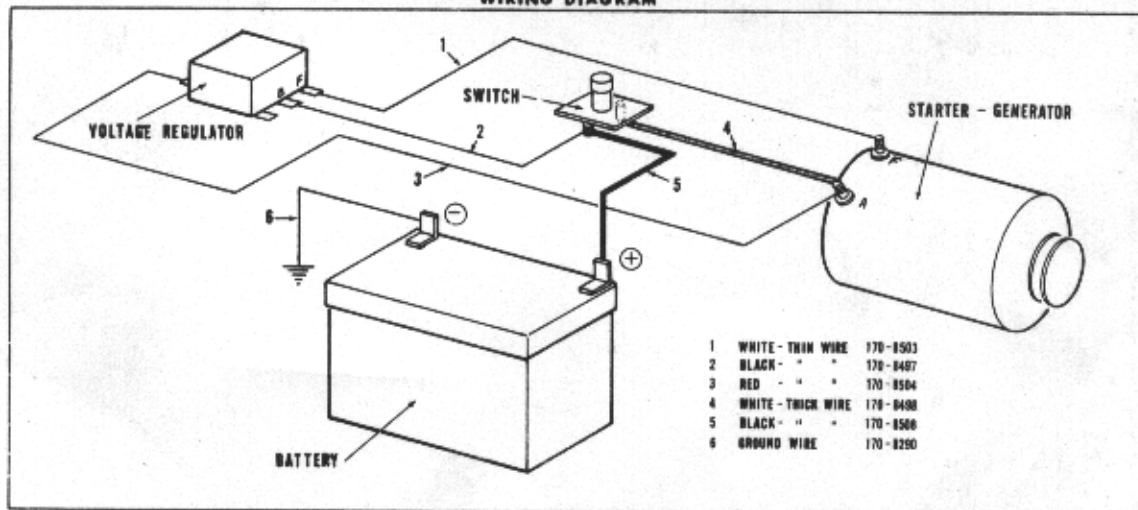

BOLENS DIVISION
 Port Washington - Wisconsin

